

# LEADER<sup>®</sup> PUMPS

## TECHNICAL CATALOGUE



# 2019

**DAB PUMPS S.p.A.**  
**[www.dabpumps.com](http://www.dabpumps.com)**

**DAB PUMPS Inc.**  
**<https://www.dabpumps.us>**

# INDEX

---

## IRRIGATION

ECOJET

ECOPLUS

INOXPLUS

---

## WATER SYSTEM

ECODIVER

DIVERTRON

ECORAIN

---

## WATER GARDENING

CLEAR ANSWER

SOLID ANSWER

---

## UTILITY

VERTYGO

ECOSUB

BVP BVPMAX

ECOVORT

---

## BOOSTER SYSTEM

EBS

ECOTRONIC

ECOMATIC

---

## ACCESSORIES

FILTER HOUSING

FILTER CARTRIDGE

HYDROTRONIC

# ECOJET



## GENERAL DATA

### Applications

Self-priming centrifugal pump with excellent suction capacity even when there are air bubbles and small particles of sand in the water.

Used especially for supplying water to domestic installations. Ideal for use in small scale agriculture and gardening services wherever self-priming operation is necessary.

### Constructional features of the pump

Technopolymer pump body and motor support.

Technopolymer impeller, diffuser, venturi and nozzle.

Carbon/ceramic mechanical seal.

### Constructional features of the motor

Induction motor, closed and cooled with external ventilation.

Rotor mounted on oversized greased sealed-for-life ball bearings to ensure silent running and a long life.

Built-in thermal and current overload protection on ECOJET 110

Built-in thermal and resettable overload protection on ECOJET 120/130

Capacitor permanently in circuit.

Manufactured according to UL 778 -2010 & CSA 108-1

Motor protection: NEMA3

Terminal Box protection: NEMA3

Insulation class: F

Standard voltage: 115v 60Hz

# TECHNICAL DATA

## MATERIALS

| N° | PARTS*          | MATERIALS                                           |
|----|-----------------|-----------------------------------------------------|
| 1  | PUMP BODY       | TECHNOPOLYMER                                       |
| 2  | IMPELLER        | TECHNOPOLYMER                                       |
| 3  | ROTOR SHAFT     | AISI 416 STAINLESS STEEL<br>UNI EN 10088-1 X12CrS13 |
| 4  | MECHANICAL SEAL | CARBON - CERAMIC                                    |
| 5  | 'O' RING        | NBR RUBBER                                          |
| 6  | NOZZLE-VENTURI  | TECHNOPOLYMER                                       |
| 7  | DIFFUSER        | TECHNOPOLYMER                                       |

\* In contact with liquid

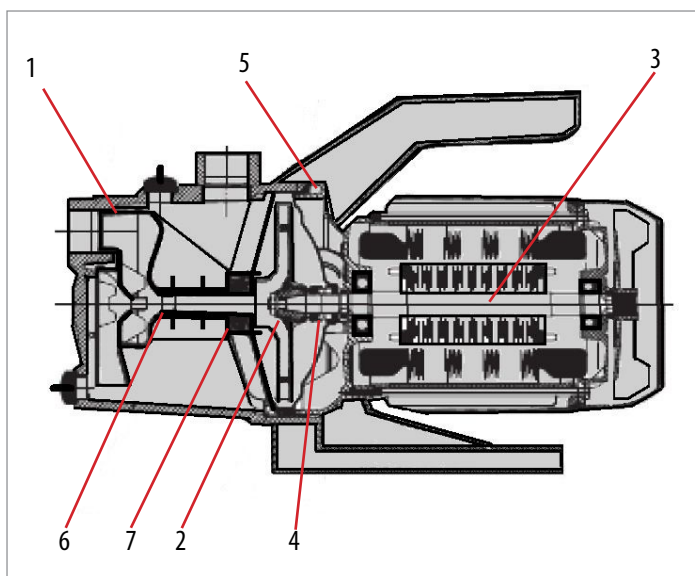

|                              |                                                                                                                                                                |
|------------------------------|----------------------------------------------------------------------------------------------------------------------------------------------------------------|
| Operating Range:             | From 1 to 21gpm with a head up to 164ft ( 71 psi )                                                                                                             |
| Liquid quality requirements: | clean, free from solids or abrasive substances,<br>non viscous, non aggressive, non crystallized, chemically<br>neutral, close to the characteristics of water |
| Liquid temperature Range:    | From 32°F to 95°F                                                                                                                                              |
| Maximum Suction depth:       | 26 ft                                                                                                                                                          |
| Maximum ambient temp.        | 104°F                                                                                                                                                          |
| Maximum operating pressure   | 87 psi                                                                                                                                                         |
| Installation:                | fixed or portable in a horizontal position                                                                                                                     |
| Special version on request   | other voltages and/or frequencies                                                                                                                              |

# ECOJET R 90

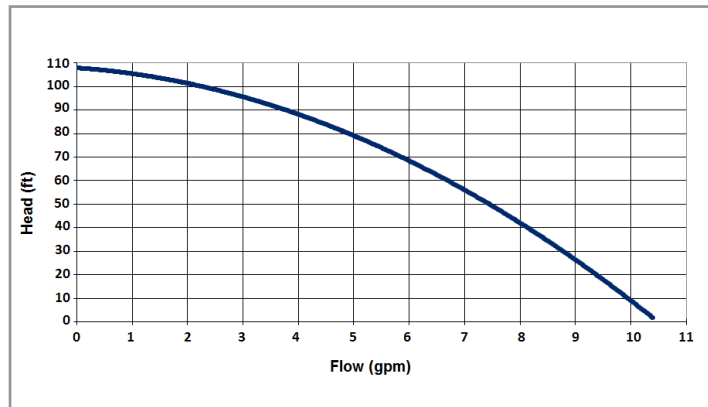
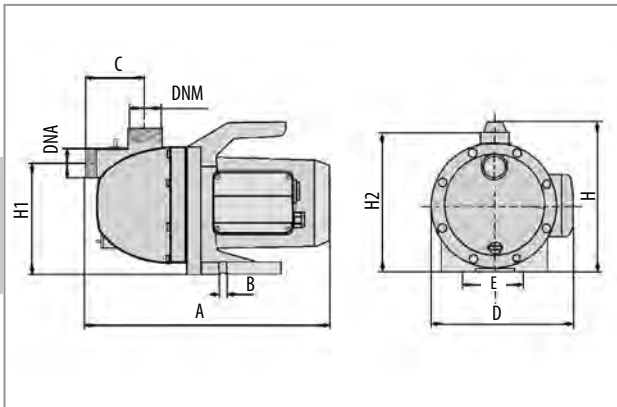

| MODEL       | A       | B    | C      | D      | E      | H      | H1 | H2 | DNA    | DNM    | Weight   |
|-------------|---------|------|--------|--------|--------|--------|----|----|--------|--------|----------|
| ECOJET R 90 | 14 1/4" | 3/8" | 3 5/8" | 8 1/4" | 5 1/2" | 8 3/4" | 6" | 8" | 1" NPT | 1" NPT | 13.5 lbs |

| MODEL       | ELECTRICAL DATA |                |     |         | HYDRAULIC DATA |             |                 |
|-------------|-----------------|----------------|-----|---------|----------------|-------------|-----------------|
|             | Voltage<br>60Hz | P1<br>kW    Hp |     | In<br>A | MAX<br>Flow    | Max<br>Head | Max<br>Pressure |
| ECOJET R 90 | 115v            | 600            | 1/3 | 6.3     | 10.4 gpm       | 108 ft      | 47 psi          |

# ECOJET 110

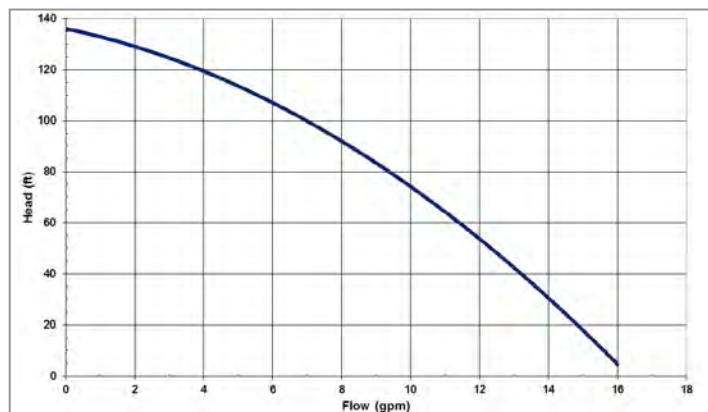
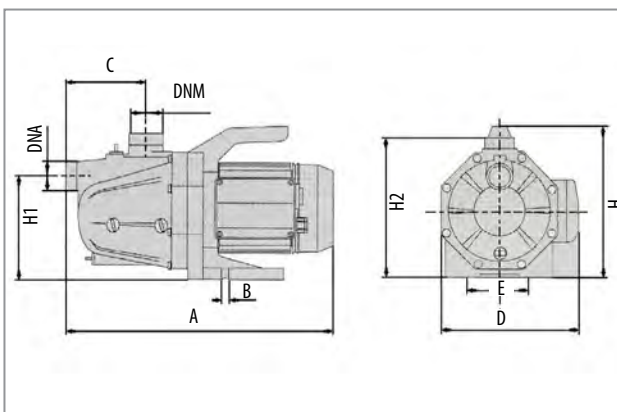

| MODEL      | A       | B    | C      | D      | E      | H      | H1     | H2     | DNA    | DNM    | Weight   |
|------------|---------|------|--------|--------|--------|--------|--------|--------|--------|--------|----------|
| ECOJET 110 | 15 3/4" | 3/8" | 4 5/8" | 8 3/4" | 5 3/4" | 9 1/2" | 6 1/2" | 9 1/8" | 1" NPT | 1" NPT | 19.2 lbs |

| MODEL      | ELECTRICAL DATA |                |     |         | HYDRAULIC DATA |             |                 |
|------------|-----------------|----------------|-----|---------|----------------|-------------|-----------------|
|            | Voltage<br>60Hz | P1<br>kW    Hp |     | In<br>A | MAX<br>Flow    | Max<br>Head | Max<br>Pressure |
| ECOJET 110 | 115v            | 800            | 1/2 | 7.8     | 16 gpm         | 138 ft      | 60 psi          |

# ECOJET 120

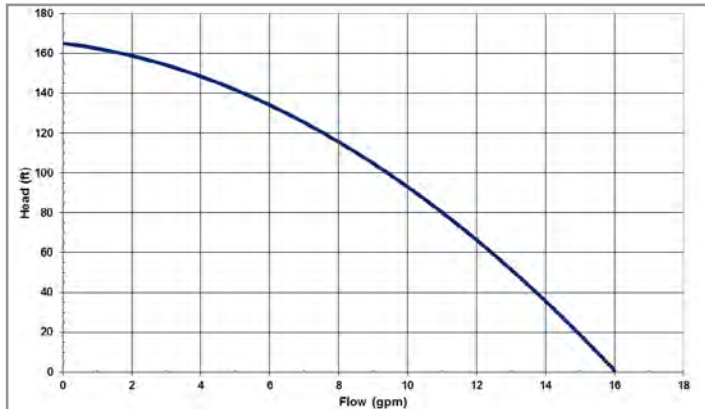
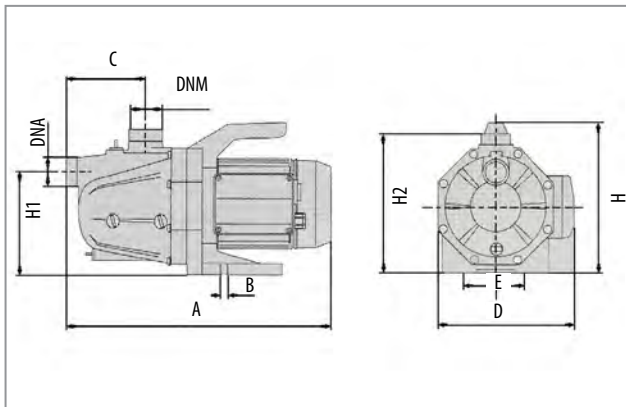

| MODEL      | A                                | B                             | C                               | D                               | E                               | H                               | H1                              | H2                              | DNA    | DNM    | Weight   |
|------------|----------------------------------|-------------------------------|---------------------------------|---------------------------------|---------------------------------|---------------------------------|---------------------------------|---------------------------------|--------|--------|----------|
| ECOJET 120 | 15 <sup>3</sup> / <sub>4</sub> " | <sup>3</sup> / <sub>8</sub> " | 4 <sup>5</sup> / <sub>8</sub> " | 8 <sup>3</sup> / <sub>4</sub> " | 5 <sup>3</sup> / <sub>4</sub> " | 9 <sup>1</sup> / <sub>2</sub> " | 6 <sup>1</sup> / <sub>2</sub> " | 9 <sup>1</sup> / <sub>8</sub> " | 1" NPT | 1" NPT | 20.7 lbs |

| MODEL      | ELECTRICAL DATA |    |    |         | HYDRAULIC DATA |             |                 |
|------------|-----------------|----|----|---------|----------------|-------------|-----------------|
|            | Voltage<br>60Hz | P1 |    | In<br>A | MAX<br>Flow    | Max<br>Head | Max<br>Pressure |
| ECOJET 120 | 115v            | kW | Hp | 9.8     | 16 gpm         | 164 ft      | 71 psi          |

# ECOJET 130

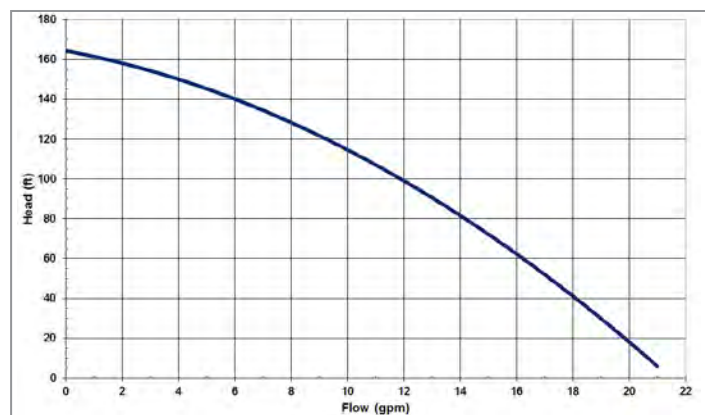
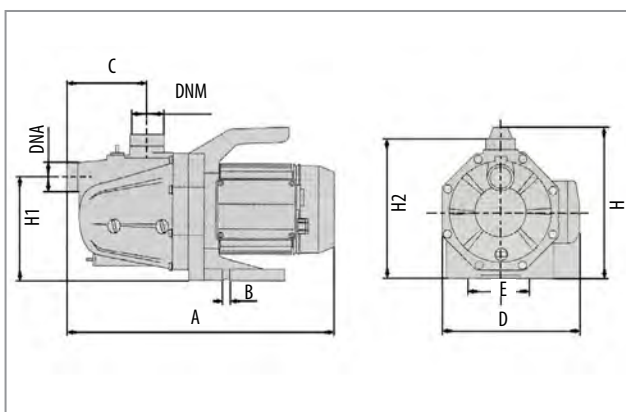

| MODEL      | A                                | B                             | C                               | D                               | E                               | H                               | H1                              | H2                              | DNA    | DNM    | Weight   |
|------------|----------------------------------|-------------------------------|---------------------------------|---------------------------------|---------------------------------|---------------------------------|---------------------------------|---------------------------------|--------|--------|----------|
| ECOJET 130 | 15 <sup>3</sup> / <sub>4</sub> " | <sup>3</sup> / <sub>8</sub> " | 4 <sup>5</sup> / <sub>8</sub> " | 8 <sup>3</sup> / <sub>4</sub> " | 5 <sup>3</sup> / <sub>4</sub> " | 9 <sup>1</sup> / <sub>2</sub> " | 6 <sup>1</sup> / <sub>2</sub> " | 9 <sup>1</sup> / <sub>8</sub> " | 1" NPT | 1" NPT | 23.4 lbs |

| MODEL      | ELECTRICAL DATA |    |    |         | HYDRAULIC DATA |             |                 |
|------------|-----------------|----|----|---------|----------------|-------------|-----------------|
|            | Voltage<br>60Hz | P1 |    | In<br>A | MAX<br>Flow    | Max<br>Head | Max<br>Pressure |
| ECOJET 130 | 115v            | kW | Hp | 11.8    | 21 gpm         | 164 ft      | 71 psi          |

# ECOPLUS



## GENERAL DATA

### Applications

Multi-stage, self priming centrifugal pump with horizontal shaft, with optimal liquid aspiration even in the presence of air bubbles, featuring extremely quiet operation suitable for domestic water supply and pressurization, irrigation of gardens and general water movement.

### Constructional features of the pump

Technopolymer pump body and motor support.

Technopolymer impeller, diffuser, self-priming disc.

Carbon/ceramic mechanical seal.

### Constructional features of the motor

Induction motor, closed and cooled with external ventilation.

Rotor mounted on oversized greased sealed-for-life ball bearings to ensure silent running and a long life.

Built-in thermal and current overload protection on ECOPLUS230

Built-in thermal and resettable overload protection on ECOPLUS 240/250

Capacitor permanently in circuit.

Manufactured according to UL 778 -2010 & CSA 108-1

Motor protection: NEMA3

Terminal Box protection: NEMA3

Insulation class: F

Standard voltage: 115v 60Hz



# TECHNICAL DATA

## MATERIALS

| N° | PARTS*          | MATERIALS                                           |
|----|-----------------|-----------------------------------------------------|
| 1  | SUCTION FLANGE  | TECHNOPOLYMER                                       |
| 2  | INSERT          | NICKLED BRASS                                       |
| 3  | NUT             | A2 – UNI7474 STAINLESS STEEL                        |
| 4  | WASHER          | A2 STAINLESS STEEL                                  |
| 5  | OR GASKET       | NBR                                                 |
| 6  | COUNTERFLANGE   | TECHNOPOLYMER                                       |
| 7  | OR GASKET       | NBR                                                 |
| 8  | DIFFUSER        | TECHNOPOLYMER                                       |
| 9  | IMPELLER        | TECHNOPOLYMER                                       |
| 10 | ROTOR SHAFT     | AISI 416 STAINLESS STEEL<br>UNI EN 10088-1 X12CrS13 |
| 11 | WASHER          | A2 STAINLESS STEEL                                  |
| 12 | SEEGER RING     | AISI 316 STAINLESS STEEL                            |
| 13 | MECHANICAL SEAL | SILICON - VITON                                     |
| 14 | COUNTERFACE     | STEAL/NBR                                           |
| 15 | BODY            | TECHNOPOLYMER                                       |
| 16 | INSERT          | NICKLED BRASS                                       |

\* In contact with liquid

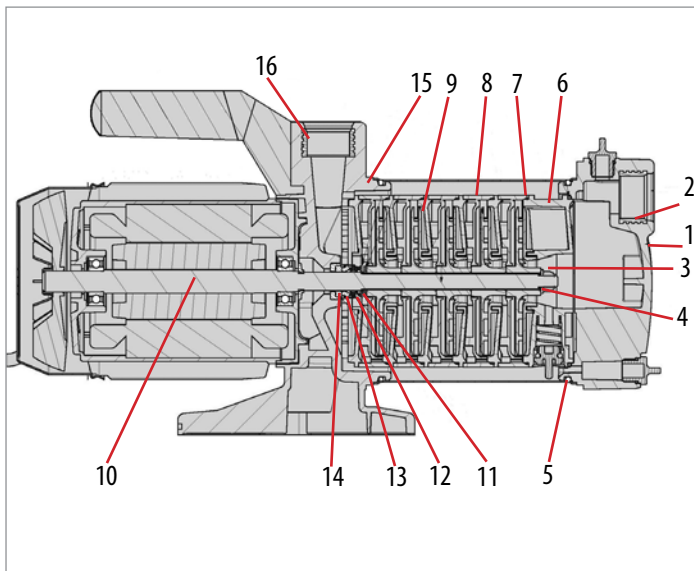

|                              |                                                                                                                                                                |
|------------------------------|----------------------------------------------------------------------------------------------------------------------------------------------------------------|
| Operating Range:             | From 1 to 27gpm with a head up to 197ft ( 85 psi )                                                                                                             |
| Liquid quality requirements: | clean, free from solids or abrasive substances,<br>non viscous, non aggressive, non crystallized, chemically<br>neutral, close to the characteristics of water |
| Liquid temperature Range:    | From 32°F to 95°F                                                                                                                                              |
| Maximum Suction depth:       | 26 ft                                                                                                                                                          |
| Maximum ambient temp.        | 104°F                                                                                                                                                          |
| Maximum operating pressure   | 116 psi                                                                                                                                                        |
| Installation:                | fixed or portable in a horizontal position                                                                                                                     |
| Special version on request   | other voltages and/or frequencies                                                                                                                              |

# ECOPLUS 230

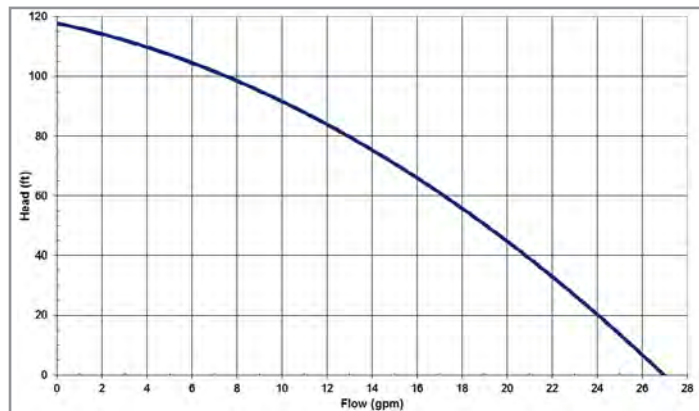
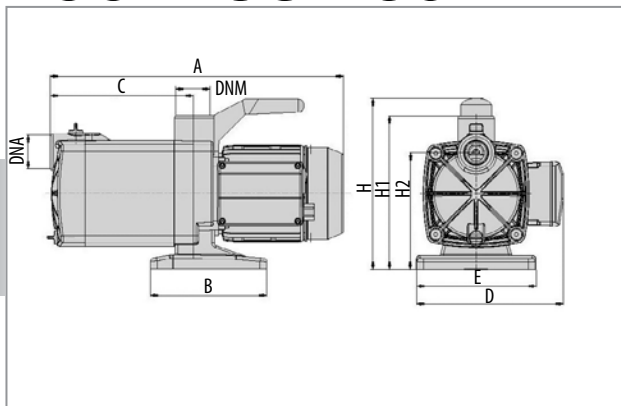

| MODEL       | A       | B      | C      | D      | E      | H      | H1     | H2     | DNA    | DNM    | Weight   |
|-------------|---------|--------|--------|--------|--------|--------|--------|--------|--------|--------|----------|
| ECOPLUS 230 | 16 1/8" | 6 3/4" | 7 1/8" | 8 1/2" | 5 5/8" | 9 5/8" | 8 3/4" | 6 5/8" | 1" NPT | 1" NPT | 19.0 lbs |

| MODEL       | ELECTRICAL DATA |               |     |         | HYDRAULIC DATA |             |                 |
|-------------|-----------------|---------------|-----|---------|----------------|-------------|-----------------|
|             | Voltage<br>60Hz | P1<br>kW   Hp |     | In<br>A | MAX<br>Flow    | Max<br>Head | Max<br>Pressure |
| ECOPLUS 230 | 115v            | 800           | 1/2 | 8.0     | 27 gpm         | 118 ft      | 51 psi          |

# ECOPLUS 240

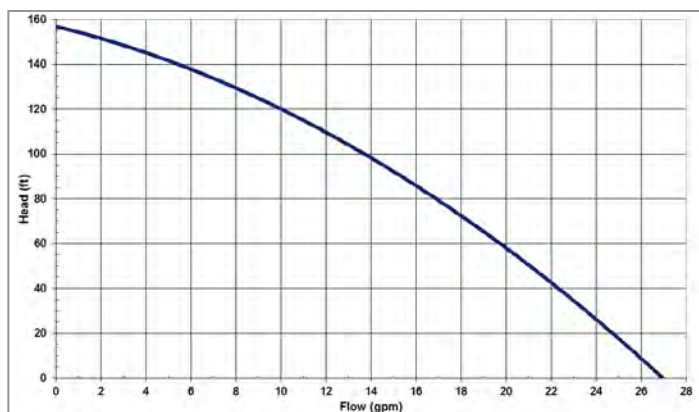
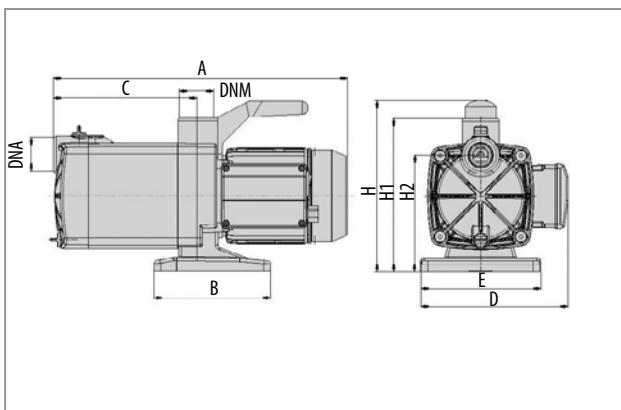

| MODEL       | A   | B      | C      | D      | E      | H      | H1     | H2     | DNA    | DNM    | Weight   |
|-------------|-----|--------|--------|--------|--------|--------|--------|--------|--------|--------|----------|
| ECOPLUS 240 | 17" | 6 3/4" | 8 1/4" | 8 1/2" | 5 5/8" | 9 5/8" | 8 3/4" | 6 5/8" | 1" NPT | 1" NPT | 26.0 lbs |

| MODEL       | ELECTRICAL DATA |               |     |         | HYDRAULIC DATA |             |                 |
|-------------|-----------------|---------------|-----|---------|----------------|-------------|-----------------|
|             | Voltage<br>60Hz | P1<br>kW   Hp |     | In<br>A | MAX<br>Flow    | Max<br>Head | Max<br>Pressure |
| ECOPLUS 240 | 115v            | 1000          | 3/4 | 10.0    | 27 gpm         | 157 ft      | 68 psi          |

# ECOPLUS 250

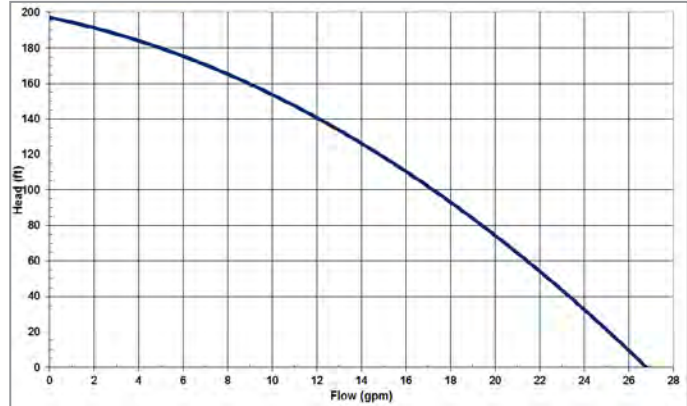
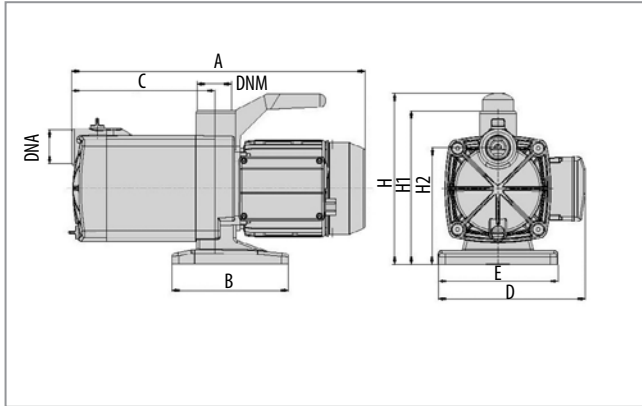

| MODEL       | A   | B                               | C                               | D                               | E                               | H                               | H1                              | H2                              | DNA    | DNM    | Weight   |
|-------------|-----|---------------------------------|---------------------------------|---------------------------------|---------------------------------|---------------------------------|---------------------------------|---------------------------------|--------|--------|----------|
| ECOPLUS 250 | 18" | 6 <sup>3</sup> / <sub>4</sub> " | 9 <sup>1</sup> / <sub>4</sub> " | 8 <sup>1</sup> / <sub>2</sub> " | 5 <sup>5</sup> / <sub>8</sub> " | 9 <sup>5</sup> / <sub>8</sub> " | 8 <sup>3</sup> / <sub>4</sub> " | 6 <sup>5</sup> / <sub>8</sub> " | 1" NPT | 1" NPT | 27.4 lbs |

| MODEL       | ELECTRICAL DATA |    |    |         | HYDRAULIC DATA |             |                 |
|-------------|-----------------|----|----|---------|----------------|-------------|-----------------|
|             | Voltage<br>60Hz | P1 |    | In<br>A | MAX<br>Flow    | Max<br>Head | Max<br>Pressure |
| ECOPLUS 250 | 115v            | kW | Hp | 13.0    | 27 gpm         | 197 ft      | 85 psi          |

# INOXPLUS



## GENERAL DATA

### Applications

Multi-stage, self priming centrifugal pump with horizontal shaft, with optimal liquid aspiration even in the presence of air bubbles, featuring extremely quiet operation suitable for domestic water supply and pressurization, irrigation of gardens and general water movement.

### Constructional features of the pump

Stainless Steel pump body.

Technopolymer impeller, diffuser, self-priming disc and motor support.

Carbon/ceramic mechanical seal.

### Constructional features of the motor

Induction motor, closed and cooled with external ventilation.

Rotor mounted on oversized greased sealed-for-life ball bearings to ensure silent running and a long life.

Built-in thermal and current overload protection on INOXPLUS230

Built-in thermal and resettable overload protection on INOXPLUS 240/250

Capacitor permanently in circuit.

Manufactured according to UL 778 -2010 & CSA 108-1

Motor protection: NEMA3

Terminal Box protection: NEMA3

Insulation class: F

Standard voltage: 115v 60Hz

# TECHNICAL DATA

## MATERIALS

| N° | PARTS*          | MATERIALS                                           |
|----|-----------------|-----------------------------------------------------|
| 1  | SUCTION FLANGE  | TECHNOPOLYMER                                       |
| 2  | INSERT          | NICKLED BRASS                                       |
| 3  | NUT             | A2 – UNI7474 STAINLESS STEEL                        |
| 4  | WASHER          | A2 STAINLESS STEEL                                  |
| 5  | OR GASKET       | NBR                                                 |
| 6  | COUNTERFLANGE   | TECHNOPOLYMER                                       |
| 7  | OR GASKET       | NBR                                                 |
| 8  | DIFFUSER        | TECHNOPOLYMER                                       |
| 9  | IMPELLER        | TECHNOPOLYMER                                       |
| 10 | ROTOR SHAFT     | AISI 416 STAINLESS STEEL<br>UNI EN 10088-1 X12CrS13 |
| 11 | WASHER          | A2 STAINLESS STEEL                                  |
| 12 | SEEGER RING     | AISI 316 STAINLESS STEEL                            |
| 13 | MECHANICAL SEAL | SILICON - VITON                                     |
| 14 | COUNTERFACE     | STEA/NBR                                            |
| 15 | BODY            | STAINLESS STEEL AISI 304                            |
| 16 | INSERT          | NICKLED BRASS                                       |

\* In contact with liquid

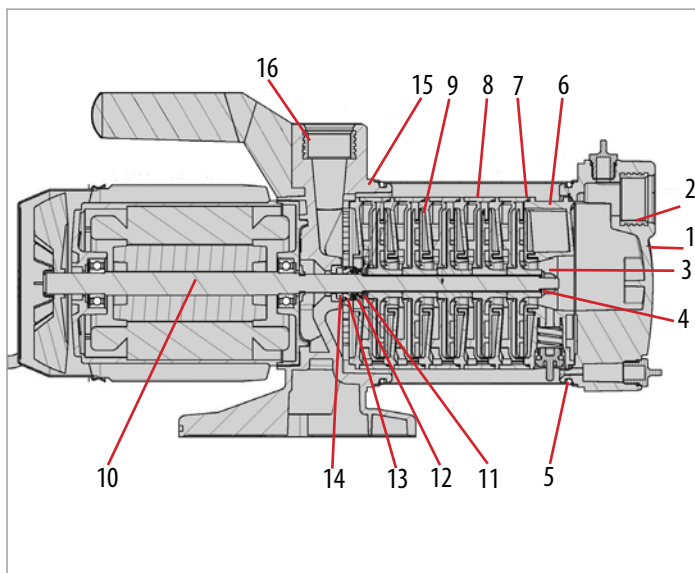

|                              |                                                                                                                                                                |
|------------------------------|----------------------------------------------------------------------------------------------------------------------------------------------------------------|
| Operating Range:             | From 1 to 27gpm with a head up to 197ft ( 85 psi )                                                                                                             |
| Liquid quality requirements: | clean, free from solids or abrasive substances,<br>non viscous, non aggressive, non crystallized, chemically<br>neutral, close to the characteristics of water |
| Liquid temperature Range:    | From 32°F to 95°F                                                                                                                                              |
| Maximum Suction depth:       | 26 ft                                                                                                                                                          |
| Maximum ambient temp.        | 104°F                                                                                                                                                          |
| Maximum operating pressure   | 116 psi                                                                                                                                                        |
| Installation:                | fixed or portable in a horizontal position                                                                                                                     |
| Special version on request   | other voltages and/or frequencies                                                                                                                              |

# INOXPLUS 230

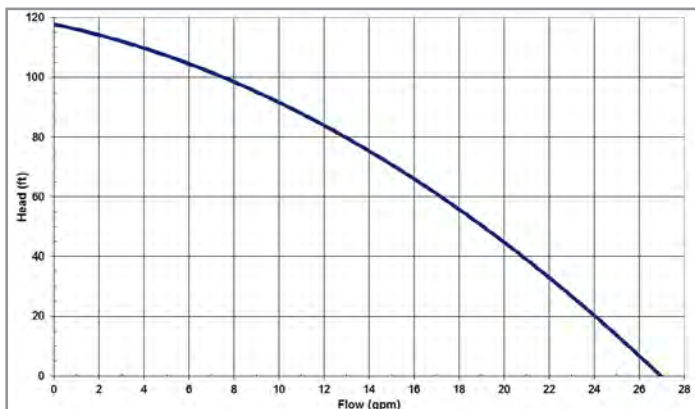
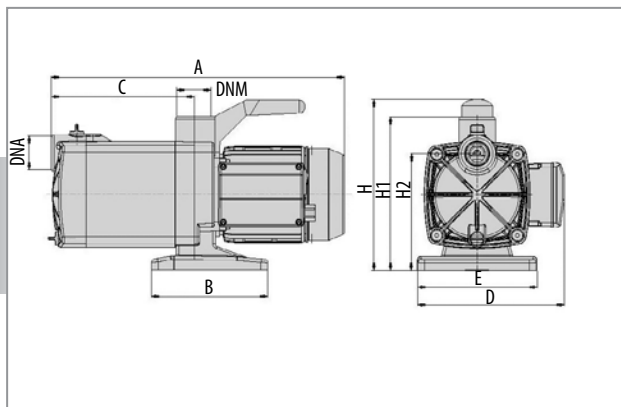

| MODEL        | A       | B      | C      | D      | E      | H      | H1     | H2     | DNA    | DNM    | Weight   |
|--------------|---------|--------|--------|--------|--------|--------|--------|--------|--------|--------|----------|
| INOXPLUS 230 | 16 1/8" | 6 3/4" | 7 1/8" | 8 1/2" | 5 5/8" | 9 5/8" | 8 3/4" | 6 5/8" | 1" NPT | 1" NPT | 18.5 lbs |

| MODEL        | ELECTRICAL DATA |               |     |         | HYDRAULIC DATA |             |                 |
|--------------|-----------------|---------------|-----|---------|----------------|-------------|-----------------|
|              | Voltage<br>60Hz | P1<br>kW   Hp |     | In<br>A | MAX<br>Flow    | Max<br>Head | Max<br>Pressure |
| INOXPLUS 230 | 115v            | 800           | 1/2 | 7.5     | 27 gpm         | 118 ft      | 51 psi          |

# INOXPLUS 240

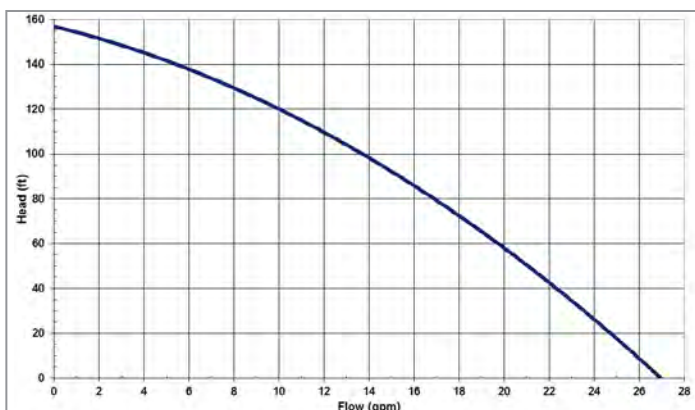
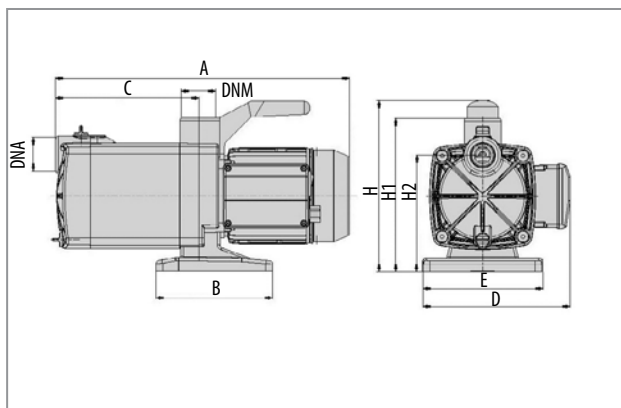

| MODEL        | A   | B      | C      | D      | E      | H      | H1     | H2     | DNA    | DNM    | Weight   |
|--------------|-----|--------|--------|--------|--------|--------|--------|--------|--------|--------|----------|
| INOXPLUS 240 | 17" | 6 3/4" | 8 1/4" | 8 1/2" | 5 5/8" | 9 5/8" | 8 3/4" | 6 5/8" | 1" NPT | 1" NPT | 26.0 lbs |

| MODEL        | ELECTRICAL DATA |               |     |         | HYDRAULIC DATA |             |                 |
|--------------|-----------------|---------------|-----|---------|----------------|-------------|-----------------|
|              | Voltage<br>60Hz | P1<br>kW   Hp |     | In<br>A | MAX<br>Flow    | Max<br>Head | Max<br>Pressure |
| INOXPLUS 240 | 115v            | 1000          | 3/4 | 10.0    | 27 gpm         | 157 ft      | 68 psi          |

# INOXPLUS 250

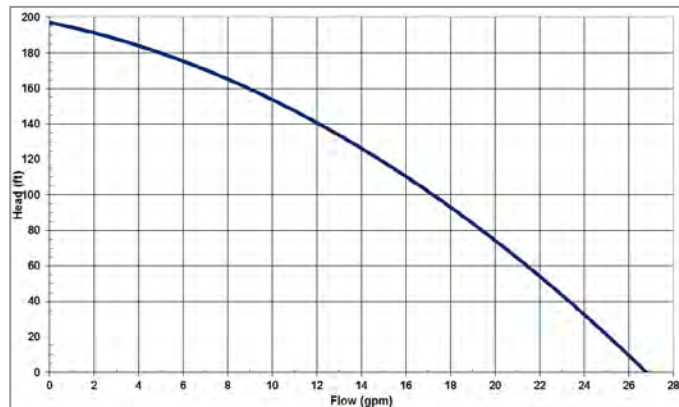
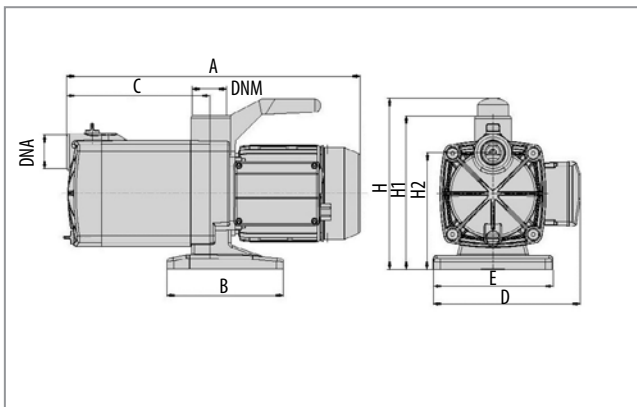

| MODEL        | A    | B                               | C                               | D                               | E                               | H                               | H1                              | H2                              | DNA    | DNM    | Weight   |
|--------------|------|---------------------------------|---------------------------------|---------------------------------|---------------------------------|---------------------------------|---------------------------------|---------------------------------|--------|--------|----------|
| INOXPLUS 250 | 18 " | 6 <sup>3</sup> / <sub>4</sub> " | 9 <sup>1</sup> / <sub>4</sub> " | 8 <sup>1</sup> / <sub>2</sub> " | 5 <sup>5</sup> / <sub>8</sub> " | 9 <sup>5</sup> / <sub>8</sub> " | 8 <sup>3</sup> / <sub>4</sub> " | 6 <sup>5</sup> / <sub>8</sub> " | 1" NPT | 1" NPT | 26.5 lbs |

| MODEL        | ELECTRICAL DATA |    |    |         | HYDRAULIC DATA |             |                 |
|--------------|-----------------|----|----|---------|----------------|-------------|-----------------|
|              | Voltage<br>60Hz | P1 |    | In<br>A | MAX<br>Flow    | Max<br>Head | Max<br>Pressure |
| INOXPLUS 250 | 115v            | kW | Hp | 13.0    | 27 gpm         | 197 ft      | 85 psi          |

# ECODIVER



## GENERAL DATA

### Applications

Multi-stage powerful submersible pumps ideal for rain water systems, operating sprinklers, pumping water from tanks, cisterns, ponds and wells and other applications that require high pressure.

Available with 2, 3 and 4 impellers. Suitable to pump clear water.

### Constructional features of the pump

Technopolymer pump body.

Technopolymer impeller, diffuser, self-priming disc.

Anti-debris stainless steel strainer.

### Constructional features of the motor

Induction motor, closed and cooled with liquid being pumped

Wear resistant shaft with triple lip seals to ensure a long life.

Built-in thermic overload protection

Capacitor permanently in circuit.

Manufactured according to UL 778 -2010 & CSA 108-1

Motor protection: NEMA6P

Insulation class: F

Cable Length: 16ft

Standard voltage: 115v 60Hz



# TECHNICAL DATA

## MATERIALS

| N° | PARTS*          | MATERIALS                |
|----|-----------------|--------------------------|
| 1  | PUMP BODY       | PP 30% GF NAT. GRADE 6   |
| 2  | DISCHARGE HEAD  | PP 30% GF NAT. GRADE 5   |
| 3  | PUMP BASE       | PP 30% NAT. GRADE 6      |
| 4  | IMPELLER        | NORYL                    |
| 5  | SUCTION         | STAINLESS STEEL          |
| 6  | DIFFUSER        | NORYL                    |
| 7  | ROTOR SHAFT     | AISI 416 STAINLESS STEEL |
| 8  | MOTOR CASING    | DIE CAST ALUMINIUM       |
| 9  | 'O' RING        | NBR 70                   |
| 10 | TRIPLE LIP SEAL | NBR 70                   |
| 11 | PUMP SHAFT      | AISI 303 STAINLESS STEEL |
| 12 | LOCK NUT        | STAINLESS STEEL A2       |
| 13 | 'O' RING        | NBR 70                   |
| 14 | WASHER          | STAINLESS STEEL A2       |

\* In contact with liquid

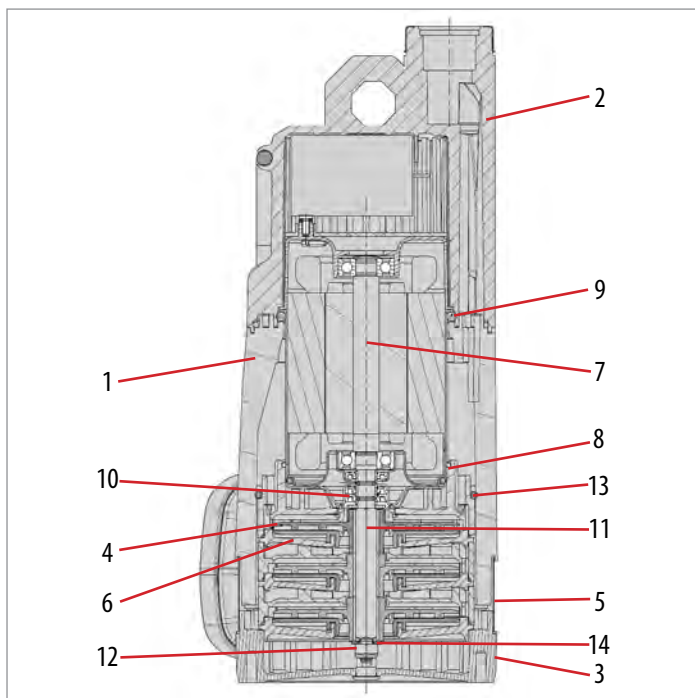

|                              |                                                                                                                                                          |
|------------------------------|----------------------------------------------------------------------------------------------------------------------------------------------------------|
| Operating Range:             | From 1 to 26 gpm with a head up to 157ft (68psi)                                                                                                         |
| Liquid quality requirements: | clean, free from solids or abrasive substances, non viscous, non aggressive, non crystallized, chemically neutral, close to the characteristics of water |
| Liquid temperature Range:    | From 32°F to 95°F                                                                                                                                        |
| Maximum ambient temp.        | 104°F                                                                                                                                                    |
| Maximum operating pressure   | 87 psi                                                                                                                                                   |
| Maximum submersion           | 33 ft                                                                                                                                                    |
| Installation:                | fixed or portable in a vertical position                                                                                                                 |
| Special version on request   | other voltages and/or frequencies                                                                                                                        |

# ECODIVER 750

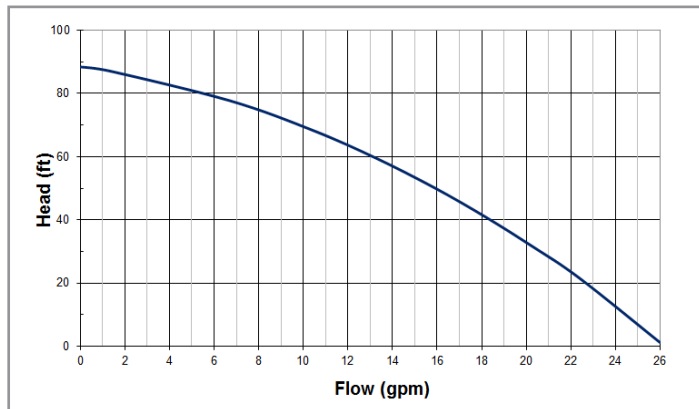
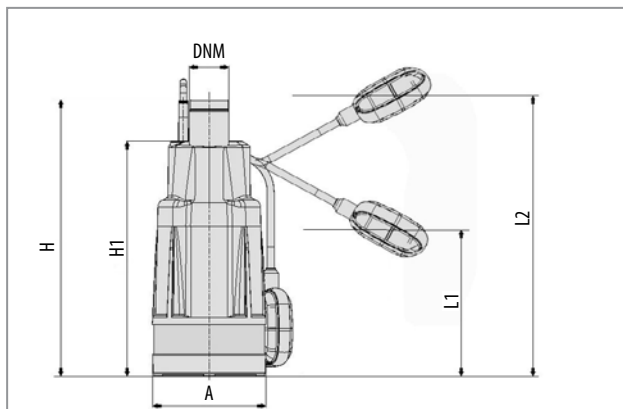

| MODEL          | A                               | H                                | H1                               | L1  | L2   | DNM    | Weight   |
|----------------|---------------------------------|----------------------------------|----------------------------------|-----|------|--------|----------|
| ECODIVER 750   | 5 <sup>7</sup> / <sub>8</sub> " | 14 <sup>5</sup> / <sub>8</sub> " | 12 <sup>1</sup> / <sub>2</sub> " | N/A | N/A  | 1" NPT | 18.1 lbs |
| ECODIVER 750 A | 5 <sup>7</sup> / <sub>8</sub> " | 14 <sup>5</sup> / <sub>8</sub> " | 12 <sup>1</sup> / <sub>2</sub> " | 4 " | 12 " | 1" NPT | 18.3 lbs |

| MODEL        | ELECTRICAL DATA |    |    |         | HYDRAULIC DATA |             |                 |
|--------------|-----------------|----|----|---------|----------------|-------------|-----------------|
|              | Voltage<br>60Hz | P1 |    | In<br>A | MAX<br>Flow    | Max<br>Head | Max<br>Pressure |
| ECODIVER 750 | 115v            | kW | Hp | 8.0     | 26 gpm         | 89 ft       | 38 psi          |

# ECODIVER 1000

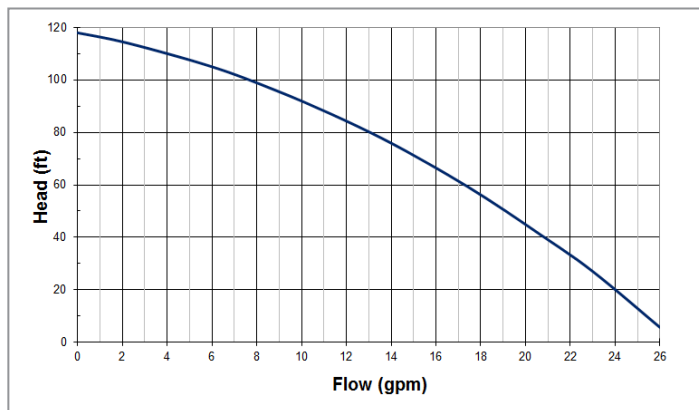
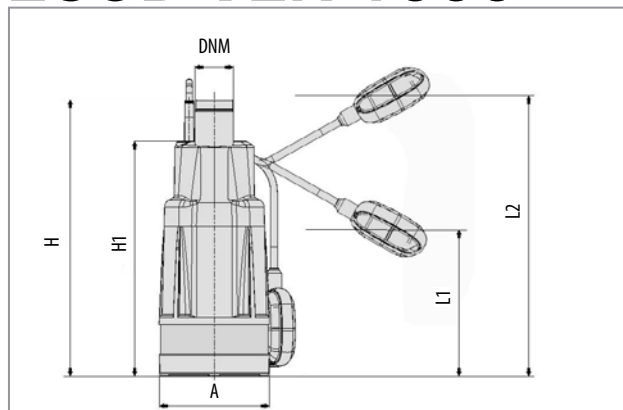

| MODEL           | A                               | H                                | H1                               | L1  | L2   | DNM    | Weight   |
|-----------------|---------------------------------|----------------------------------|----------------------------------|-----|------|--------|----------|
| ECODIVER 1000   | 5 <sup>7</sup> / <sub>8</sub> " | 14 <sup>5</sup> / <sub>8</sub> " | 12 <sup>1</sup> / <sub>2</sub> " | N/A | N/A  | 1" NPT | 19.0 lbs |
| ECODIVER 1000 A | 5 <sup>7</sup> / <sub>8</sub> " | 14 <sup>5</sup> / <sub>8</sub> " | 12 <sup>1</sup> / <sub>2</sub> " | 4 " | 12 " | 1" NPT | 19.2 lbs |

| MODEL         | ELECTRICAL DATA |    |    |         | HYDRAULIC DATA |             |                 |
|---------------|-----------------|----|----|---------|----------------|-------------|-----------------|
|               | Voltage<br>60Hz | P1 |    | In<br>A | MAX<br>Flow    | Max<br>Head | Max<br>Pressure |
| ECODIVER 1000 | 115v            | kW | Hp | 9.0     | 26 gpm         | 118 ft      | 52 psi          |

# ECODIVER 1200

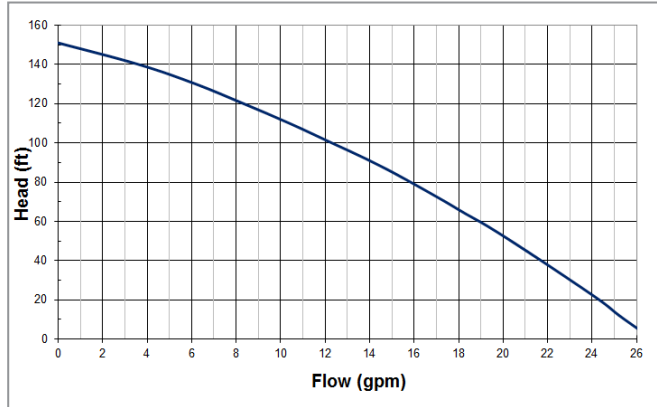
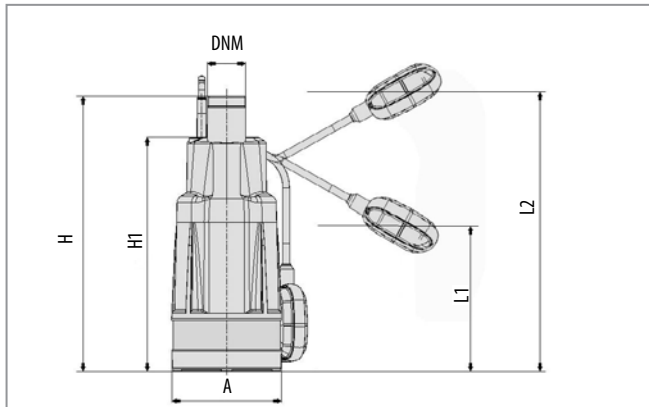

| MODEL           | A                               | H                                | H1                               | L1  | L2   | DNM    | Weight   |
|-----------------|---------------------------------|----------------------------------|----------------------------------|-----|------|--------|----------|
| ECODIVER 1200   | 5 <sup>7</sup> / <sub>8</sub> " | 14 <sup>5</sup> / <sub>8</sub> " | 12 <sup>1</sup> / <sub>2</sub> " | N/A | N/A  | 1" NPT | 19.4 lbs |
| ECODIVER 1200 A | 5 <sup>7</sup> / <sub>8</sub> " | 14 <sup>5</sup> / <sub>8</sub> " | 12 <sup>1</sup> / <sub>2</sub> " | 4 " | 12 " | 1" NPT | 19.6 lbs |

| MODEL         | ELECTRICAL DATA |    |    |         | HYDRAULIC DATA |             |                 |
|---------------|-----------------|----|----|---------|----------------|-------------|-----------------|
|               | Voltage<br>60Hz | P1 |    | In<br>A | MAX<br>Flow    | Max<br>Head | Max<br>Pressure |
| ECODIVER 1200 | 115v            | kW | Hp | 10      | 26 gpm         | 157 ft      | 68 psi          |

# DIVERTRON



## GENERAL DATA

### Applications

Multi-stage powerful submersible pumps with electronic control system, ideal for rain water systems, operating sprinklers, pumping water from tanks, cisterns, ponds and wells and other applications that require high pressure.

Available with 3 or 4 impellers. Suitable to pump clear water.

### Constructional features of the pump

Technopolymer pump body.

Technopolymer impeller, diffuser, self-priming disc.

Anti-debris stainless steel strainer on DIVERTRON

Stainless Steel suction ring on DIVERTRON X

### Constructional features of the motor

Induction motor, closed and cooled with liquid being pumped

Wear resistant shaft with triple lip seals to ensure a long life.

Built-in thermic overload protection

Capacitor permanently in circuit.

Manufactured according to UL 778 -2010 & CSA 108-1

Motor protection: NEMA6P

Insulation class: F

Cable Length: 50ft

Standard voltage: 115v 60Hz

# TECHNICAL DATA

## MATERIALS

| N° | PARTS*          | MATERIALS                |
|----|-----------------|--------------------------|
| 1  | PUMP BODY       | PP 30% NAT. GRADE 6      |
| 2  | DISCHARGE HEAD  | PP 30% NAT. GRADE 5      |
| 3  | PUMP BASE       | PP 30% NAT. GRADE 6      |
| 4  | IMPELLER        | NORYL                    |
| 5  | SUCTION         | STAINLESS STEEL          |
| 6  | DIFFUSER        | NORYL                    |
| 7  | ROTOR SHAFT     | AISI 416 STAINLESS STEEL |
| 8  | MOTOR CASING    | DIE CAST ALUMINUM        |
| 9  | 'O' RING        | NBR 70                   |
| 10 | NRV & SENSOR    | TECHNOPOLYMER / EPDM     |
| 11 | PUMP SHAFT      | AISI 303 STAINLESS STEEL |
| 12 | LOCK NUT        | STAINLESS STEEL A2       |
| 13 | 'O' RING        | NBR 70                   |
| 14 | WASHER          | STAINLESS STEEL A3       |
| 15 | TRIPLE LIP SEAL | NBR                      |

\* In contact with liquid

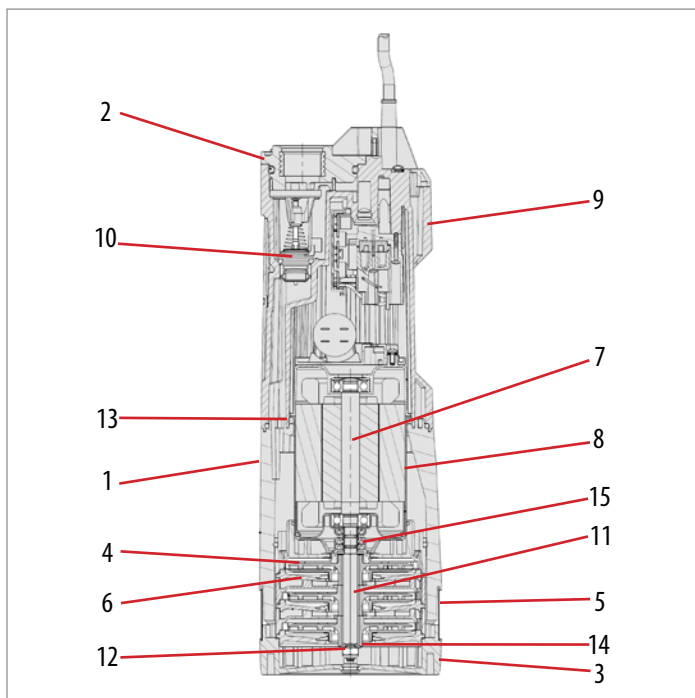

|                              |                                                                                                                                                          |
|------------------------------|----------------------------------------------------------------------------------------------------------------------------------------------------------|
| Operating Range:             | From 1 to 25 gpm with a head up to 157ft (68psi)                                                                                                         |
| Liquid quality requirements: | clean, free from solids or abrasive substances, non viscous, non aggressive, non crystallized, chemically neutral, close to the characteristics of water |
| Liquid temperature Range:    | From 32°F to 95°F                                                                                                                                        |
| Maximum ambient temp.        | 104°F                                                                                                                                                    |
| Maximum operating pressure   | 87 psi                                                                                                                                                   |
| Maximum submersion           | 49 ft                                                                                                                                                    |
| Installation:                | fixed or portable in a vertical position                                                                                                                 |
| Special version on request   | other voltages and/or frequencies                                                                                                                        |

# DIVERTRON 1000

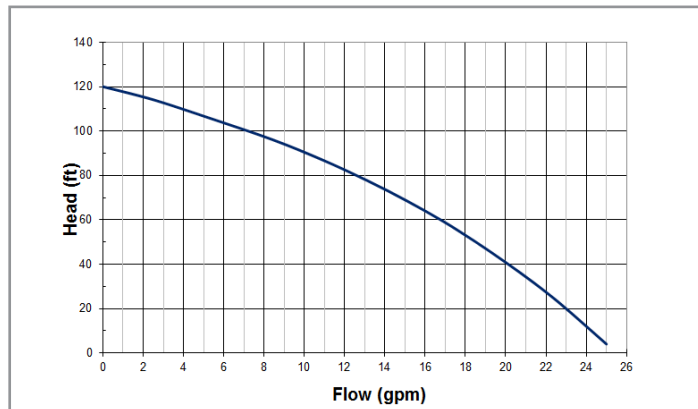
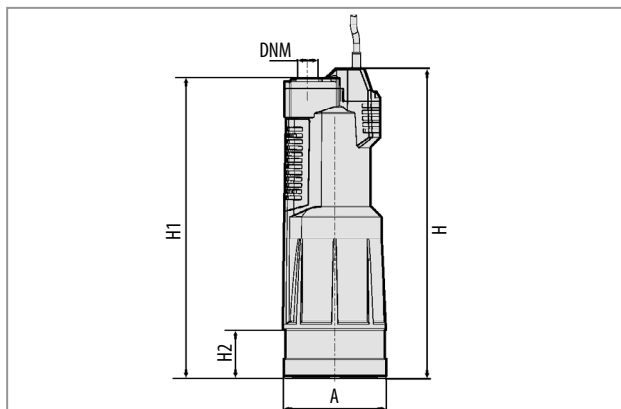

| MODEL          | A                               |  | H                                | H1                               | H2                              | DNA | DNM    | Weight   |
|----------------|---------------------------------|--|----------------------------------|----------------------------------|---------------------------------|-----|--------|----------|
| DIVERTRON 1000 | 5 <sup>7</sup> / <sub>8</sub> " |  | 17 <sup>3</sup> / <sub>4</sub> " | 17 <sup>1</sup> / <sub>8</sub> " | 1 <sup>5</sup> / <sub>8</sub> " | N/A | 1" NPT | 23.1 lbs |

| MODEL          | ELECTRICAL DATA |    |    |         | HYDRAULIC DATA |             |                 |
|----------------|-----------------|----|----|---------|----------------|-------------|-----------------|
|                | Voltage<br>60Hz | P1 |    | In<br>A | MAX<br>Flow    | Max<br>Head | Max<br>Pressure |
| DIVERTRON 1000 | 115v            | kW | Hp | 9.0     | 25 gpm         | 120 ft      | 52 psi          |

# DIVERTRON 1200

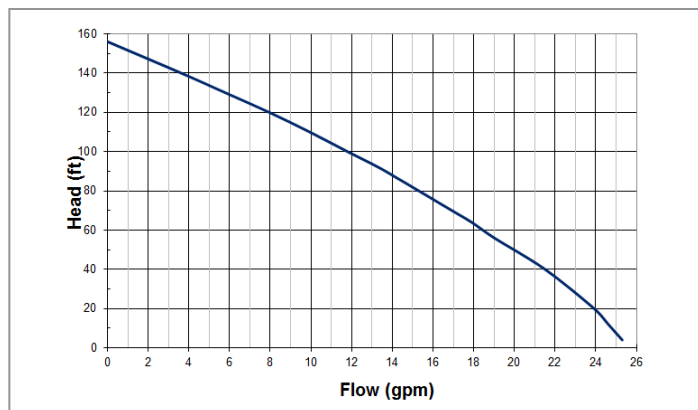
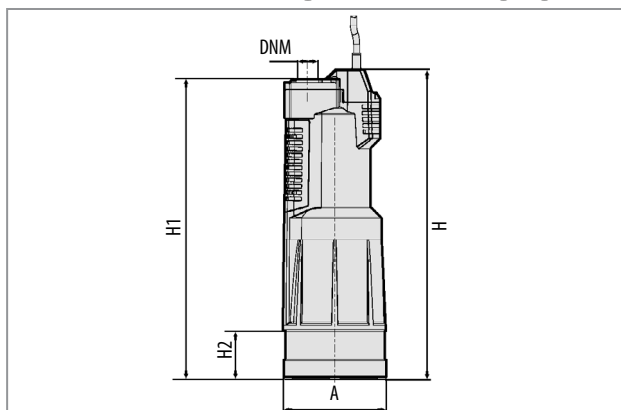

| MODEL          | A                               |  | H                                | H1                              | H2                              | DNA | DNM    | Weight   |
|----------------|---------------------------------|--|----------------------------------|---------------------------------|---------------------------------|-----|--------|----------|
| DIVERTRON 1200 | 5 <sup>7</sup> / <sub>8</sub> " |  | 18 <sup>7</sup> / <sub>8</sub> " | 8 <sup>1</sup> / <sub>8</sub> " | 2 <sup>3</sup> / <sub>4</sub> " | N/A | 1" NPT | 23.6 lbs |

| MODEL          | ELECTRICAL DATA |    |    |         | HYDRAULIC DATA |             |                 |
|----------------|-----------------|----|----|---------|----------------|-------------|-----------------|
|                | Voltage<br>60Hz | P1 |    | In<br>A | MAX<br>Flow    | Max<br>Head | Max<br>Pressure |
| DIVERTRON 1200 | 115v            | kW | Hp | 10.0    | 25 gpm         | 157 ft      | 68 psi          |

# DIVERTRON 1200X

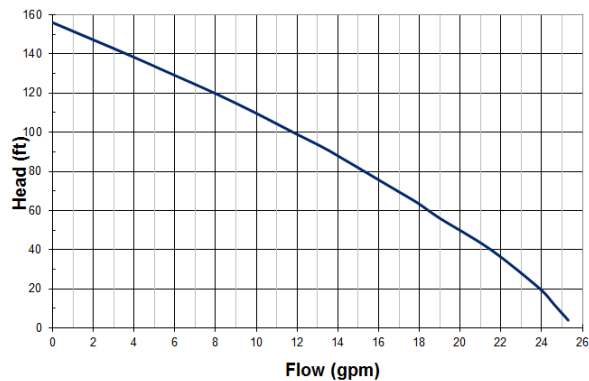
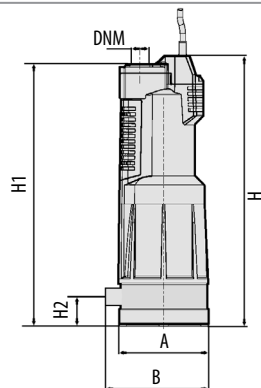

| MODEL           | A                               | B                               | H                                | H1                               | H2                              | DNA    | DNM    | Weight   |
|-----------------|---------------------------------|---------------------------------|----------------------------------|----------------------------------|---------------------------------|--------|--------|----------|
| DIVERTRON 1200X | 5 <sup>7</sup> / <sub>8</sub> " | 6 <sup>3</sup> / <sub>4</sub> " | 18 <sup>7</sup> / <sub>8</sub> " | 18 <sup>1</sup> / <sub>4</sub> " | 2 <sup>3</sup> / <sub>4</sub> " | 1" NPT | 1" NPT | 23.8 lbs |

| MODEL           | ELECTRICAL DATA |    |    |         | HYDRAULIC DATA |             |                 |
|-----------------|-----------------|----|----|---------|----------------|-------------|-----------------|
|                 | Voltage<br>60Hz | P1 |    | In<br>A | MAX<br>Flow    | Max<br>Head | Max<br>Pressure |
| DIVERTRON 1200X | 115v            | kW | Hp | 10.0    | 25 gpm         | 157 ft      | 68 psi          |

# ECORAIN

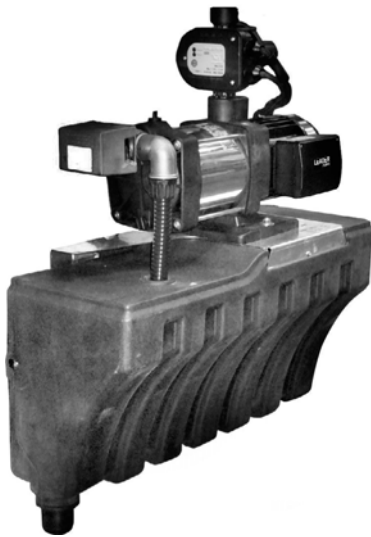

## GENERAL DATA

### Applications

**ECORAIN Essential** is a complete and pre-assembled system for using rainwater. The system comprises a recyclable polyethylene tank, an ECOPLUS 240 and Mascontrol and a three-way automatic valve assembled on suction port of the pump. The system has been designed to be wall-mounted. Supplied with wall bracket and float switch, with 65 ft. of cable, as a standard.

**ECORAIN Evolution & Advanced** are complete and pre-assembled system for using rainwater in one or two-family houses.

The system comprises a recyclable polyethylene console, a completely automatic electronic control unit, three-way automatic valve and ECOPLUS 240 electric pump.

Supplied with wall bracket as a standard and float switch with 65 ft of cable for ECORAIN Evolution version, or level sensor probe with 65 ft. of cable for ECORAIN Advanced.

### Constructional features of the pump

Technopolymer pump body and motor support.

Technopolymer impeller, diffuser, self-priming disc.

Carbon/ceramic mechanical seal.

### Constructional features of the motor

Induction motor, closed and cooled with external ventilation.

Rotor mounted on oversized greased sealed-for-life ball bearings to ensure silent running and a long life.

Built-in thermal and resettable overload protection on ECOPLUS 240

Capacitor permanently in circuit.

Manufactured according to UL 778 -2010 & CSA 108-1

Motor protection: NEMA3

Terminal Box protection: NEMA3

Insulation class: F

Standard voltage: 115v 60Hz



# TECHNICAL DATA

## MATERIALS ECORAIN ESSENTIAL

| N° | PARTS                    | MATERIALS                                                                      |
|----|--------------------------|--------------------------------------------------------------------------------|
| 1  | PUMP CONTROL             | MASCONTROL                                                                     |
| 2  | PRESSURISED WATER OUTLET | PPO 30                                                                         |
| 3  | RAIN WATER SUCTION       | STEEL HOSE                                                                     |
| 4  | 3 - WAY VALVE            | VALVE BODY - BRASS<br>RETURN SPRING - STEEL<br>MOTOR COVER - EXTINGUISHING ABS |
| 5  | BACK UP WATER TANK       | PE                                                                             |
| 6  | OVERFLOW                 | PP HOMOPOLYMER                                                                 |
| 7  | PUMP                     | ECOPLUS 240                                                                    |
| 8  | MUNICIPAL WATER INLET    | STEEL HOSE                                                                     |
| 9  | PRIMING PLUG             | PPE / O RING NBR                                                               |
| 10 | DRAIN PLUG               | PPE / O RING NBR                                                               |

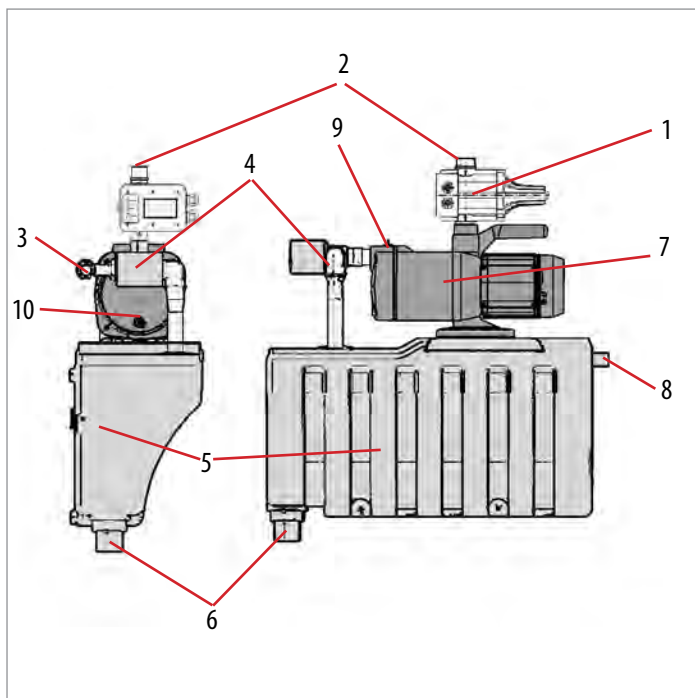

|                              |                                                                                                                                                          |
|------------------------------|----------------------------------------------------------------------------------------------------------------------------------------------------------|
| Operating Range:             | From 1 to 27 gpm with a head up to 157ft (68psi)                                                                                                         |
| Liquid quality requirements: | clean, free from solids or abrasive substances, non viscous, non aggressive, non crystallized, chemically neutral, close to the characteristics of water |
| Liquid temperature Range:    | From 32°F to 95°F                                                                                                                                        |
| Maximum suction depth        | 26 ft                                                                                                                                                    |
| Maximum ambient temp.        | 104°F                                                                                                                                                    |
| Maximum operating pressure   | 87 psi                                                                                                                                                   |
| Installation:                | fixed or portable in a vertical position                                                                                                                 |
| Special version on request   | other voltages and/or frequencies                                                                                                                        |

# TECHNICAL DATA

## EVOLUTION & ADVANCED MATERIALS

| N° | PARTS              | MATERIALS                                                                      |
|----|--------------------|--------------------------------------------------------------------------------|
| 1  | ENCLOSURE          | PP FOAM                                                                        |
| 2  | PUMP               | ECOPLUS 240                                                                    |
| 3  | PRESSURISED OUTLET | METAL HOSE                                                                     |
| 4  | RAINWATER SUCTION  | BRASS                                                                          |
| 5  | 3-WAY VALVE        | VALVE BODY - BRASS<br>RETURN SPRING - STEEL<br>MOTOR COVER - EXTINGUISHING ABS |
| 6  | PRESSURE GUAGE     | BRASS - COPPER                                                                 |
| 7  | FLOW SWITCH        | POM - NBR - STEEL                                                              |
| 8  | WATER TANK         | LLDPE                                                                          |
| 9  | CONTROL PANEL      | COVER - EXTINGUISNG ABS                                                        |
| 10 | MUNICIPAL INLET    | METAL HOSE                                                                     |
| 11 | EMERGENCY OVERFLOW | LLDPE                                                                          |
| 12 | EXPANSION TANK     | DIAPHRAGM - CHLOROBUTYL                                                        |
| 13 | CHECK VALVE        | BRASS                                                                          |
| 14 | PUMP MOUNTING      | STEEL                                                                          |
| 15 | FLOAT VALVE        | PA 66 / STEEL / POLYSTYRENE                                                    |

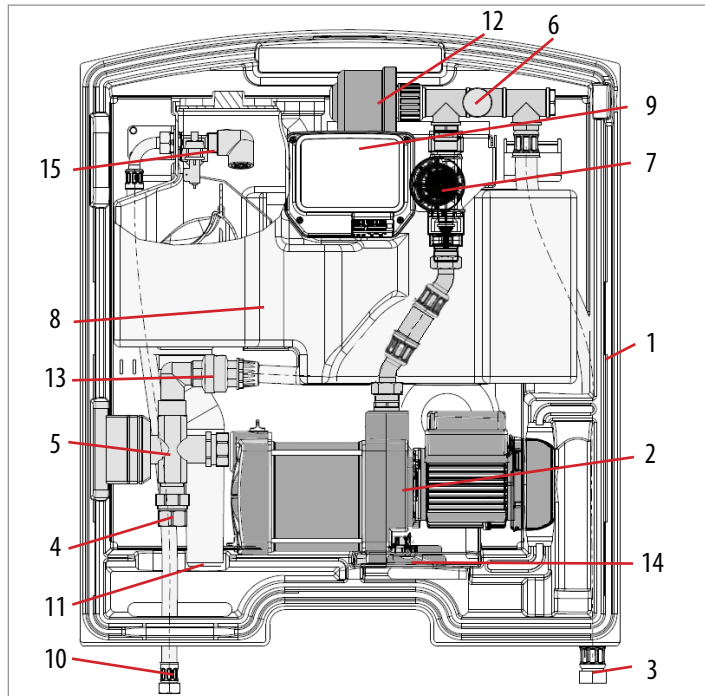

|                              |                                                                                                                                                                |
|------------------------------|----------------------------------------------------------------------------------------------------------------------------------------------------------------|
| Operating Range:             | From 1 to 27 gpm with a head up to 157ft (68psi)                                                                                                               |
| Liquid quality requirements: | clean, free from solids or abrasive substances,<br>non viscous, non aggressive, non crystallized, chemically<br>neutral, close to the characteristics of water |
| Liquid temperature Range:    | From 32°F to 104°F                                                                                                                                             |
| Maximum Suction depth:       | 26 ft                                                                                                                                                          |
| Maximum ambient temp.        | 104°F                                                                                                                                                          |
| Maximum operating pressure   | 87 psi                                                                                                                                                         |
| Installation:                | wall mounted, fixed horizontal position                                                                                                                        |
| Special version on request   | other voltages and/or frequencies                                                                                                                              |

# ECORAIN ESSENTIAL

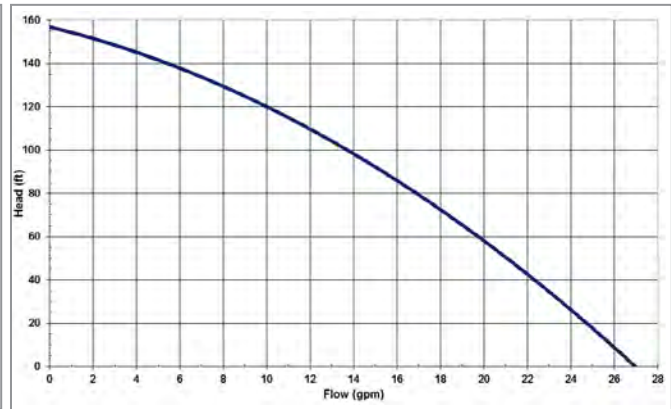
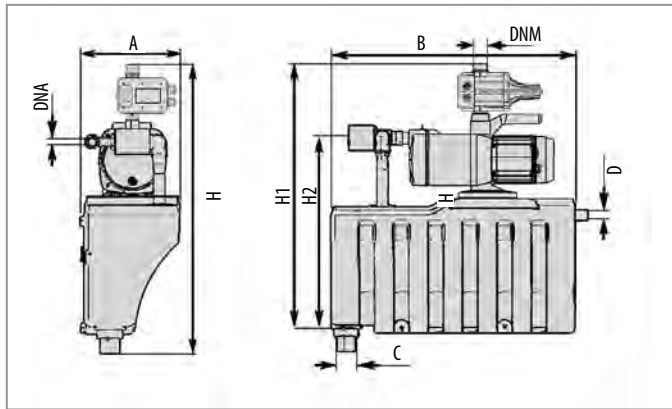

| MODEL     | A       | B       | C  | D        | H       | H1      | H2      | DNA    | DNM    | Weight   |
|-----------|---------|---------|----|----------|---------|---------|---------|--------|--------|----------|
| ESSENTIAL | 10 1/4" | 25 5/8" | 2" | 3/4" NPT | 28 3/4" | 26 1/4" | 19 3/4" | 1" NPT | 1" NPT | 39.7 lbs |

| MODEL     | ELECTRICAL DATA |          |    |         | HYDRAULIC DATA |             |                 |
|-----------|-----------------|----------|----|---------|----------------|-------------|-----------------|
|           | Voltage<br>60Hz | P1<br>kW | Hp | In<br>A | MAX<br>Flow    | Max<br>Head | Max<br>Pressure |
| ESSENTIAL | 115v            | 1100     | 1  | 10.0    | 27 gpm         | 157 ft      | 68 psi          |

# ECORAIN EVOLUTION & ADVANCED

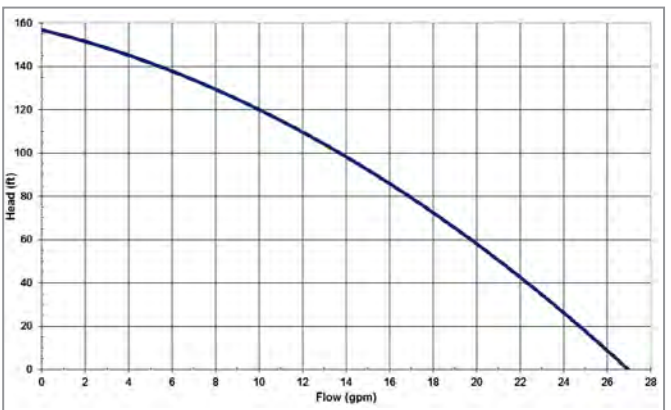
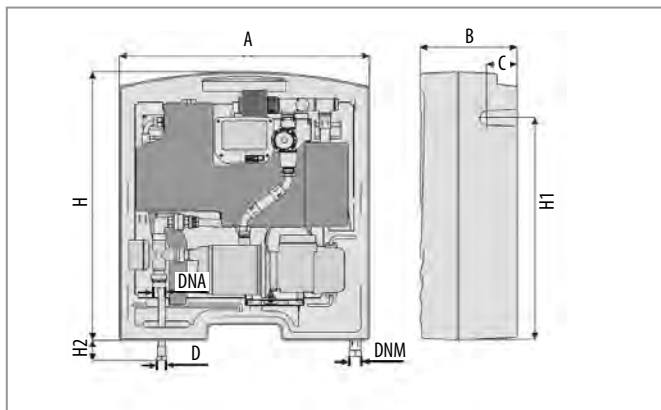

| MODEL                | A       | B       | C      | D        | H       | H1      | H2 | DNA    | DNM    | Weight   |
|----------------------|---------|---------|--------|----------|---------|---------|----|--------|--------|----------|
| ADVANCED & EVOLUTION | 29 5/8" | 11 3/8" | 5 7/8" | 3/4" NPT | 33 3/8" | 29 3/8" | 2" | 1" NPT | 1" NPT | 61.7 lbs |

| MODEL                | ELECTRICAL DATA |          |    |         | HYDRAULIC DATA |             |                 |
|----------------------|-----------------|----------|----|---------|----------------|-------------|-----------------|
|                      | Voltage<br>60Hz | P1<br>kW | Hp | In<br>A | MAX<br>Flow    | Max<br>Head | Max<br>Pressure |
| ADVANCED & EVOLUTION | 115v            | 1100     | 1  | 10.0    | 27 gpm         | 157 ft      | 68 psi          |

# CLEAR ANSWER



## GENERAL DATA

### Applications

Submersible pumps to circulate water in garden ponds, create water falls and play water features.

Designed to work in both horizontal and vertical installations

Suitable to pump clear water containing particles with maximum diameter up to 1/3".

- \* Circulating water in Garden ponds
- \* Water falls
- \* Fountains
- \* Water features

### Constructional features of the pump

Technopolymer pump body.

Technopolymer impeller.

Technopolymer suction grid pump base.

### Constructional features of the motor

Induction motor, closed and cooled with liquid being pumped

Wear resistant shaft with triple lip seals to ensure a long life.

Built-in thermic overload protection

Capacitor permanently in circuit.

Manufactured according to UL 778 -2010 & CSA 108-1

Motor protection: NEMA6P

Insulation class: F

Cable Length: 16ft

Standard voltage: 115v 60Hz

# TECHNICAL DATA

## MATERIALS

| N° | PARTS*             | MATERIALS                            |
|----|--------------------|--------------------------------------|
| 1  | PUMP BODY          | PP 30% GF NAT GRADE 6                |
| 2  | TOP BODY           | PP 30% GF NAT GRADE 5                |
| 3  | PUMP BASE          | PP 30% GF NAT GRADE 6                |
| 4  | IMPELLER           | NORYL                                |
| 5  | 'O' RING           | NBR 70                               |
| 6  | SPACER BODY        | PP 30% GF NAT GRADE 6                |
| 7  | ROTOR SHAFT        | AISI 416 STAINLESS STEEL<br>QUENCHED |
| 8  | UPPER MOTOR CASING | CAST ALUMINUM                        |
| 9  | 'O' RING           | NBR 70                               |
| 10 | TRIPLE LIP SEAL    | NBR 70                               |
| 11 | LOWER MOTOR CASING | CAST ALUMINUM                        |
| 12 | LOCK NUT           | STAINLESS STEEL 316                  |

\* In contact with liquid

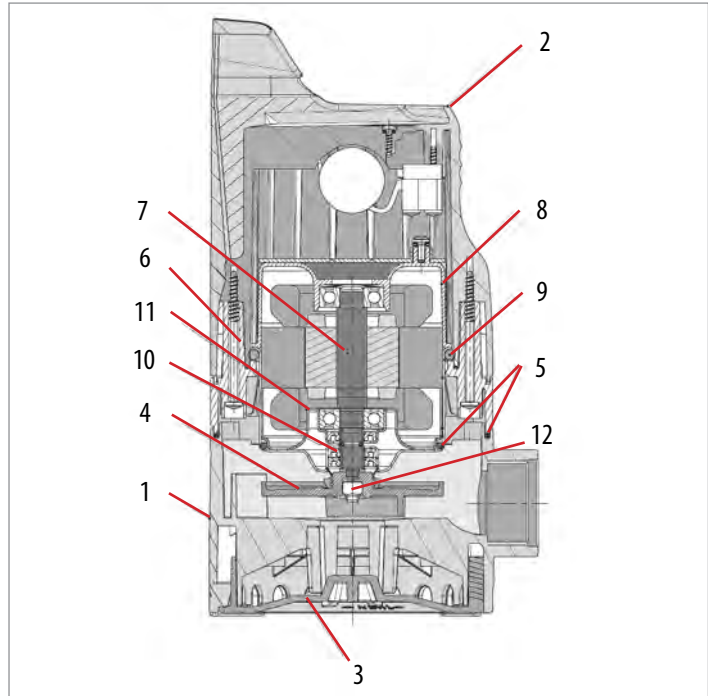

|                              |                                                                                                                                                                |
|------------------------------|----------------------------------------------------------------------------------------------------------------------------------------------------------------|
| Operating Range:             | From 5 to 70 gpm with a head up to 34ft ( 14 psi )                                                                                                             |
| Liquid quality requirements: | clean, free from solids or abrasive substances,<br>non viscous, non aggressive, non crystallized, chemically<br>neutral, close to the characteristics of water |
| Liquid temperature Range:    | From 32°F to 95°F                                                                                                                                              |
| Maximum solids               | 1/2"                                                                                                                                                           |
| Maximum ambient temp.        | 104°F                                                                                                                                                          |
| Maximum submersion           | 16 ft                                                                                                                                                          |
| Installation:                | fixed or portable in a vertical or horizontal position                                                                                                         |
| Special version on request   | other voltages and/or frequencies                                                                                                                              |

# CLEAR ANSWER 1

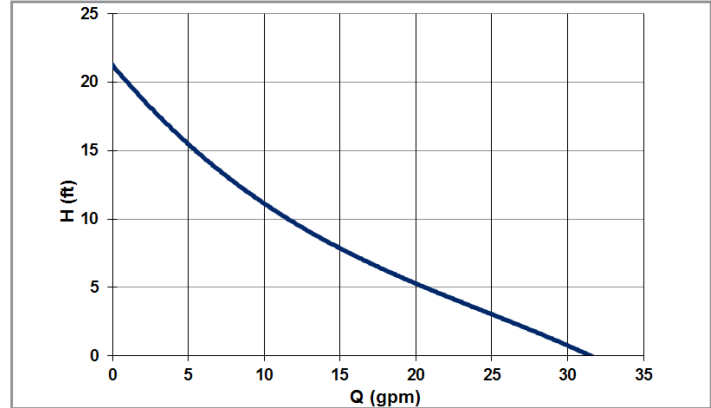
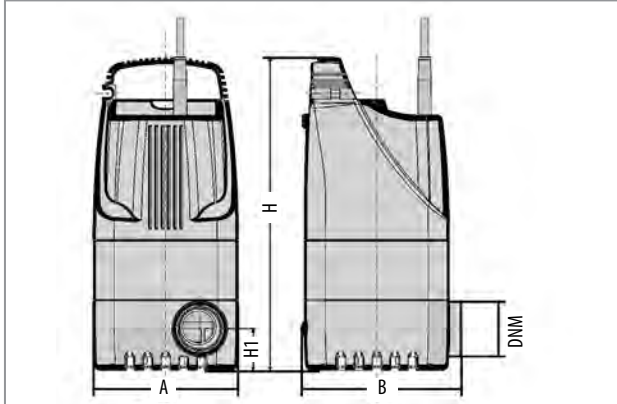

| MODEL          | A     | B | H      | H1    | DNM        | Weight  |
|----------------|-------|---|--------|-------|------------|---------|
| CLEAR ANSWER 1 | 5 1/2 | 6 | 10 1/2 | 1 1/2 | 1 1/4" NPT | 9.8 lbs |

| MODEL          | ELECTRICAL DATA |            |     |         | HYDRAULIC DATA |             |                 |
|----------------|-----------------|------------|-----|---------|----------------|-------------|-----------------|
|                | Voltage<br>60Hz | P1<br>Watt | Hp  | In<br>A | MAX<br>Flow    | Max<br>Head | Max<br>Pressure |
| CLEAR ANSWER 1 | 115v            | 260        | 1/3 | 2.4     | 31 gpm         | 21 ft       | 9 psi           |

# CLEAR ANSWER 2

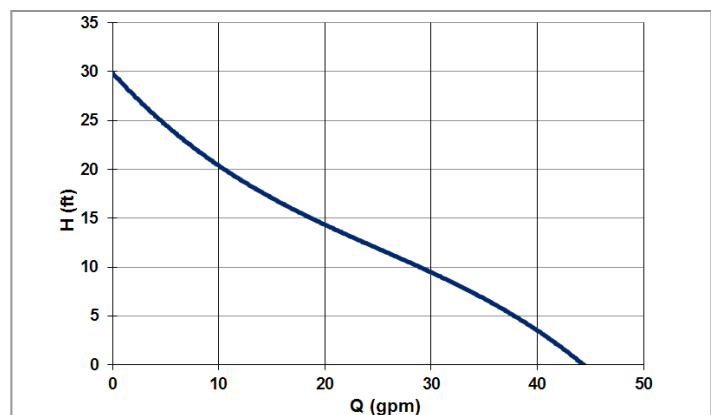
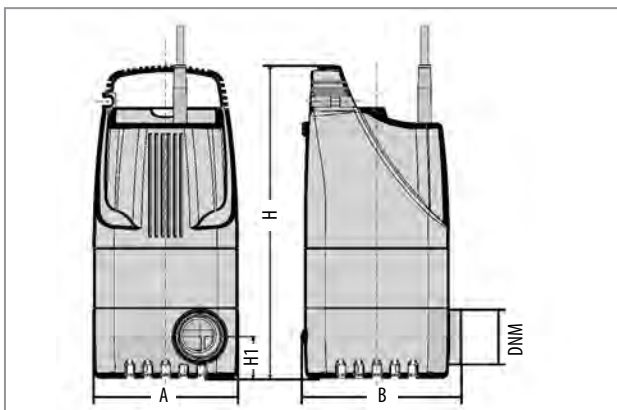

| MODEL          | A     | B | H      | H1    | DNM        | Weight   |
|----------------|-------|---|--------|-------|------------|----------|
| CLEAR ANSWER 2 | 5 1/2 | 6 | 10 1/2 | 1 1/2 | 1 1/4" NPT | 10.4 lbs |

| MODEL          | ELECTRICAL DATA |            |     |         | HYDRAULIC DATA |             |                 |
|----------------|-----------------|------------|-----|---------|----------------|-------------|-----------------|
|                | Voltage<br>60Hz | P1<br>Watt | Hp  | In<br>A | MAX<br>Flow    | Max<br>Head | Max<br>Pressure |
| CLEAR ANSWER 2 | 115v            | 370        | 1/3 | 3.4     | 44 gpm         | 29 ft       | 12 psi          |

# CLEAR ANSWER 3

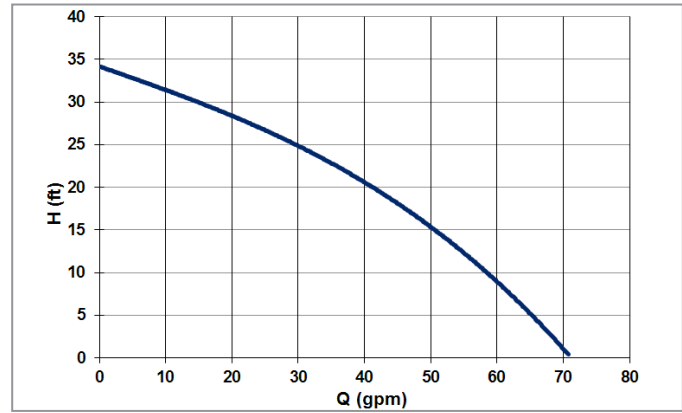
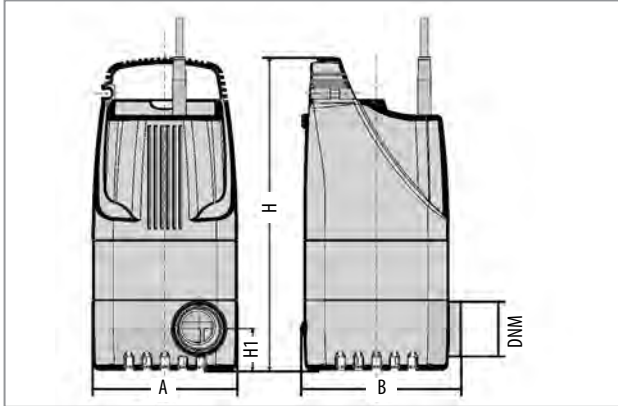

| MODEL          | A     | B | H      | H1    | DNM        | Weight   |
|----------------|-------|---|--------|-------|------------|----------|
| CLEAR ANSWER 3 | 5 1/2 | 6 | 10 1/2 | 1 1/2 | 1 1/4" NPT | 13.2 lbs |

| MODEL          | ELECTRICAL DATA |                |     |         | HYDRAULIC DATA |             |                 |
|----------------|-----------------|----------------|-----|---------|----------------|-------------|-----------------|
|                | Voltage<br>60Hz | P1<br>kW    Hp |     | In<br>A | MAX<br>Flow    | Max<br>Head | Max<br>Pressure |
| CLEAR ANSWER 3 | 115v            | 820            | 1/2 | 7.6     | 70 gpm         | 34 ft       | 14 psi          |

# SOILD ANSWER



## GENERAL DATA

### Applications

Submersible pumps to circulate water in garden ponds, create water falls and play water features.

Designed to work in both horizontal and vertical installations

Suitable to pump clear water containing particles with maximum diameter up to 1" 1/4.

- \* Circulating water in Garden ponds
- \* Water falls
- \* Fountains
- \* Water features

### Constructional features of the pump

Technopolymer pump body.

Technopolymer impeller, diffuser, self-priming disc.

Anti-debris stainless steel strainer.

### Constructional features of the motor

Induction motor, closed and cooled with liquid being pumped

Wear resistant shaft with triple lip seals to ensure a long life.

Built-in thermic overload protection

Capacitor permanently in circuit.

Manufactured according to UL 778 -2010 & CSA 108-1

Motor protection: NEMA6P

Insulation class: F

Cable Length: 16ft

Standard voltage: 115v 60Hz



# TECHNICAL DATA

## MATERIALS

| N° | PARTS*             | MATERIALS                         |
|----|--------------------|-----------------------------------|
| 1  | PUMP BODY          | PP 30% GF NAT GRADE 6             |
| 2  | TOP BODY           | PP 30% GF NAT GRADE 5             |
| 3  | WASHER             | STAINLESS STEEL A2                |
| 4  | IMPELLER           | NYLON                             |
| 5  | 'O' RING           | NBR 70                            |
| 6  | SPACER BODY        | PP 30% GF NAT GRADE 6             |
| 7  | ROTOR SHAFT        | AISI 416 STAINLESS STEEL QUENCHED |
| 8  | UPPER MOTOR CASING | CAST ALUMINUM                     |
| 9  | 'O' RING           | NBR 70                            |
| 10 | TRIPLE LIP SEAL    | NBR 70                            |
| 11 | LOWER MOTOR CASING | CAST ALUMINUM                     |
| 12 | LOCK NUT           | STAINLESS STEEL 316               |

\* In contact with liquid

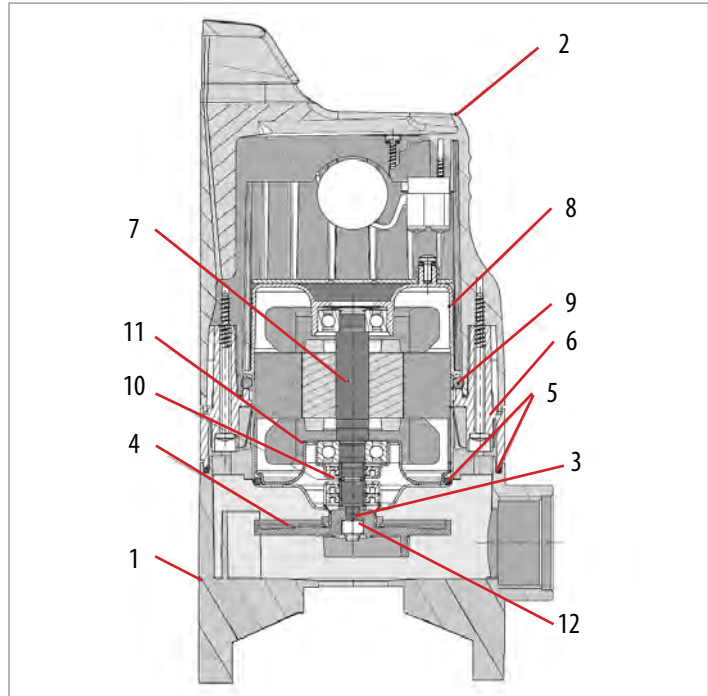

|                              |                                                                                                                                                          |
|------------------------------|----------------------------------------------------------------------------------------------------------------------------------------------------------|
| Operating Range:             | From 5 to 54 gpm with a head up to 29 1/2 ft ( 12 psi )                                                                                                  |
| Liquid quality requirements: | clean, free from solids or abrasive substances, non viscous, non aggressive, non crystallized, chemically neutral, close to the characteristics of water |
| Liquid temperature Range:    | From 32°F to 95°F                                                                                                                                        |
| Maximum solids               | 1 1/4"                                                                                                                                                   |
| Maximum ambient temp.        | 104°F                                                                                                                                                    |
| Maximum submersion           | 16 ft                                                                                                                                                    |
| Installation:                | fixed or portable in a vertical or horizontal position                                                                                                   |
| Special version on request   | other voltages and/or frequencies                                                                                                                        |

# SOLID ANSWER 4

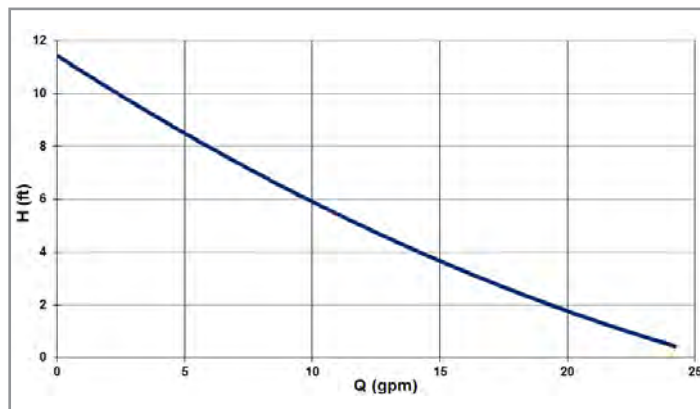
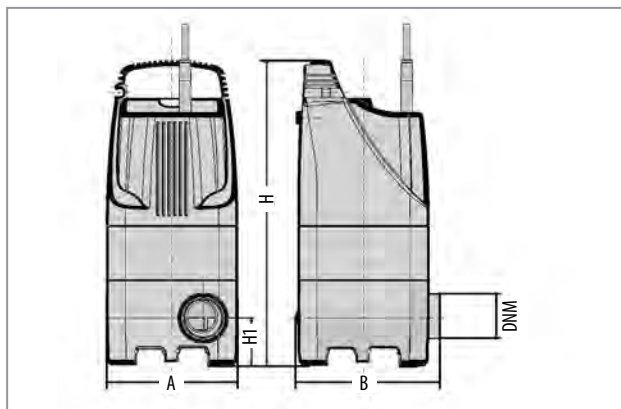

| MODEL          | A      | B  | H       | H1     | DNM        | Weight  |
|----------------|--------|----|---------|--------|------------|---------|
| SOLID ANSWER 4 | 5 1/4" | 6" | 13 7/8" | 2 1/2" | 1 1/4" NPT | 9.6 lbs |

| MODEL          | ELECTRICAL DATA |    |    |         | HYDRAULIC DATA |             |                 |
|----------------|-----------------|----|----|---------|----------------|-------------|-----------------|
|                | Voltage<br>60Hz | P1 |    | In<br>A | MAX<br>Flow    | Max<br>Head | Max<br>Pressure |
| SOLID ANSWER 4 | 115v            | kW | Hp | 1.9     | 24 gpm         | 11 1/2 ft   | 5 psi           |

# SOLID ANSWER 5

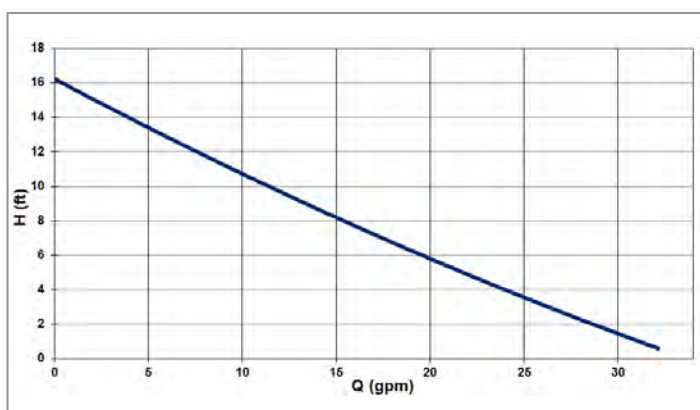
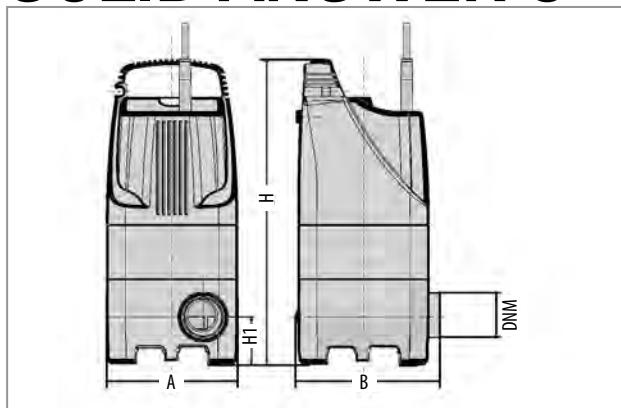

| MODEL          | A      | B  | H       | H1     | DNM        | Weight   |
|----------------|--------|----|---------|--------|------------|----------|
| SOLID ANSWER 5 | 5 1/4" | 6" | 13 7/8" | 2 1/2" | 1 1/4" NPT | 10.4 lbs |

| MODEL          | ELECTRICAL DATA |    |    |         | HYDRAULIC DATA |             |                 |
|----------------|-----------------|----|----|---------|----------------|-------------|-----------------|
|                | Voltage<br>60Hz | P1 |    | In<br>A | MAX<br>Flow    | Max<br>Head | Max<br>Pressure |
| SOLID ANSWER 5 | 115v            | kW | Hp | 2.4     | 32 gpm         | 16 1/2 ft   | 7 psi           |

# SOLID ANSWER 6

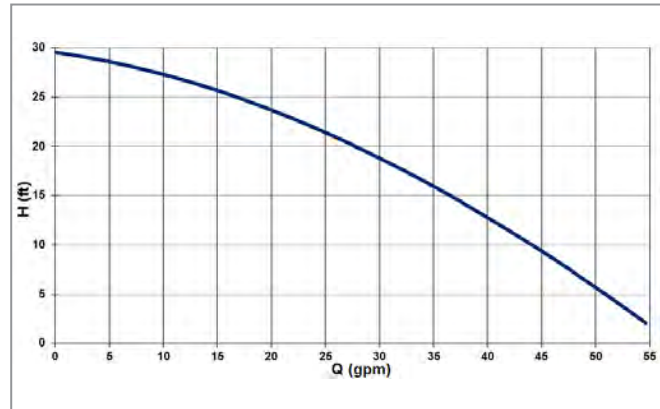
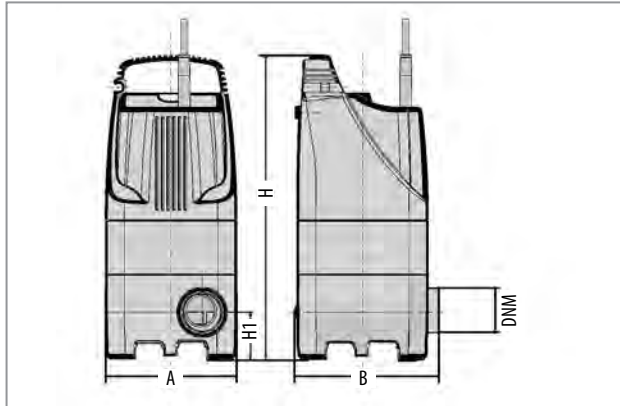

| MODEL          | A      | B  | H       | H1     | DNM        | Weight   |
|----------------|--------|----|---------|--------|------------|----------|
| SOLID ANSWER 6 | 5 1/4" | 6" | 13 7/8" | 2 1/2" | 1 1/4" NPT | 13.8 lbs |

| MODEL          | ELECTRICAL DATA |    |    |         | HYDRAULIC DATA |             |                 |
|----------------|-----------------|----|----|---------|----------------|-------------|-----------------|
|                | Voltage<br>60Hz | P1 |    | In<br>A | MAX<br>Flow    | Max<br>Head | Max<br>Pressure |
| SOLID ANSWER 6 | 115v            | kW | Hp | 8.0     | 54 gpm         | 29 1/2 ft   | 12 psi          |

# VERTY GO



## GENERAL DATA

### Applications

Multi-purpose submersible pumps for drainage, emptying, and pumping water between containers. Specifically designed for uses in narrow pits with dimensions down to 8" x 8".

Suitable to pump clear water containing particles with maximum diameter up to 1/4".

- \* Drainage
- \* Emptying sumps
- \* Transferring water between large containers
- \* Hydroponics

### Constructional features of the pump

Technopolymer pump body.

Technopolymer impeller.

Technopolymer Vertical float switch.

### Constructional features of the motor

Induction motor, closed and cooled with liquid being pumped

Wear resistant shaft with triple lip seals to ensure a long life.

Built-in thermic overload protection

Capacitor permanently in circuit.

Motor protection: NEMA6P

Insulation class: F

Cable Length: 16ft

Standard voltage: 115v 60Hz

# TECHNICAL DATA

## MATERIALS

| N° | PARTS*          | MATERIALS                |
|----|-----------------|--------------------------|
| 1  | PUMP BASE       | PP 30% GF                |
| 2  | HANDLE          | PP 20% TC                |
| 3  | LOWER HOUSING   | PP 15% GF NAT GRADE 6    |
| 4  | IMPELLER        | PP 20% GF                |
| 5  | TOP BODY        | PP 30% GF NAT GRADE 5    |
| 6  | ROTOR SHAFT     | AISI 416 STAINLESS STEEL |
| 7  | FLOAT COVER     | ABS                      |
| 8  | FLOAT ROD       | POM                      |
| 9  | MANUAL SWITCH   | PP 15% GF                |
| 10 | FLOAT           | PP 15% GF                |
| 11 | MOTOR COVER     | DIE CAST ALUMINUM        |
| 12 | TRIPLE LIP SEAL | NBR                      |

\* In contact with liquid

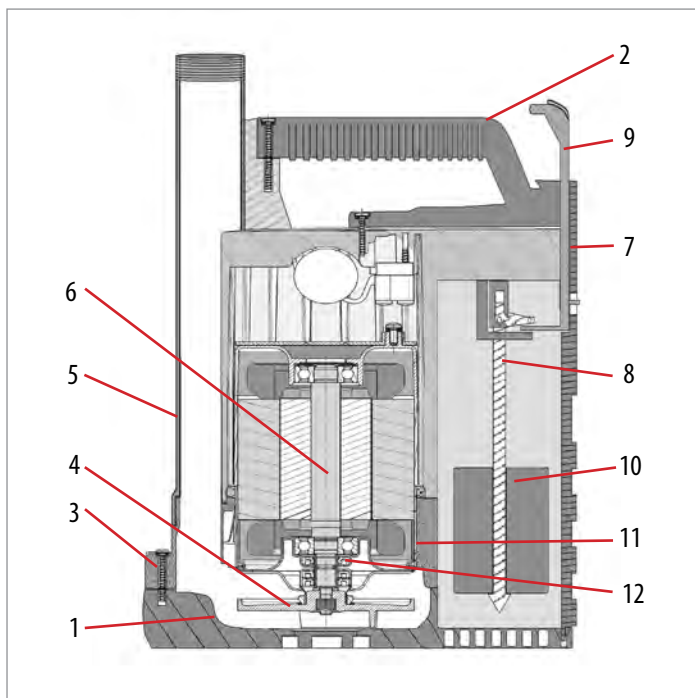

|                              |                                                                                                                                                          |
|------------------------------|----------------------------------------------------------------------------------------------------------------------------------------------------------|
| Operating Range:             | From 1 to 52 gpm with a head up to 30ft (13 psi)                                                                                                         |
| Liquid quality requirements: | clean, free from solids or abrasive substances, non viscous, non aggressive, non crystallized, chemically neutral, close to the characteristics of water |
| Liquid temperature Range:    | From 32°F to 95°F                                                                                                                                        |
| Maximum solids               | 1/4"                                                                                                                                                     |
| Maximum ambient temp.        | 104°F                                                                                                                                                    |
| Maximum operating pressure   | 13 psi                                                                                                                                                   |
| Maximum submersion           | 16 ft                                                                                                                                                    |
| Installation:                | fixed or portable in a vertical position                                                                                                                 |
| Special version on request   | other voltages and/or frequencies                                                                                                                        |

# VERTY GO 300

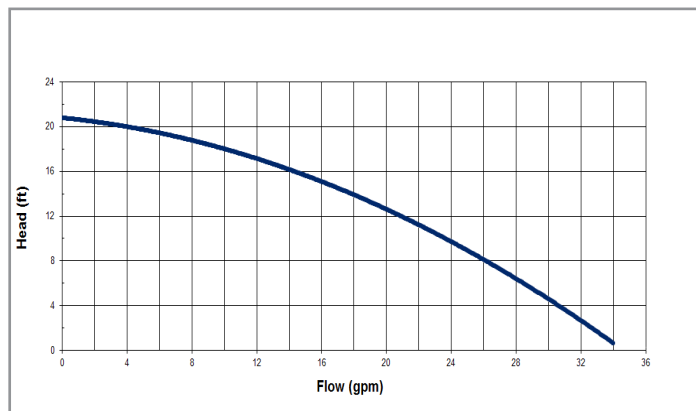
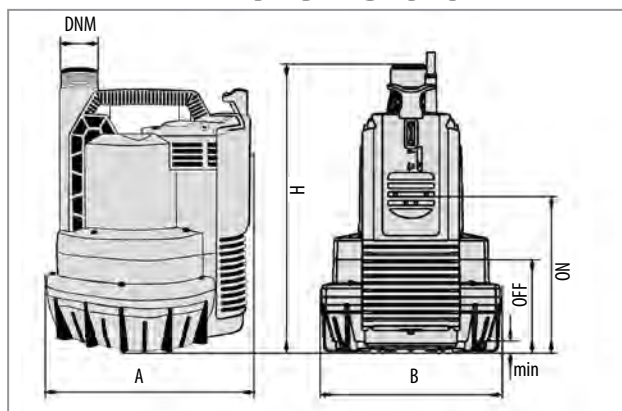

| MODEL        | A                               | B                               | H                                | ON | OFF | MIN                            | DNM                                 | Weight   |
|--------------|---------------------------------|---------------------------------|----------------------------------|----|-----|--------------------------------|-------------------------------------|----------|
| VERTY GO 300 | 8 <sup>3</sup> / <sub>4</sub> " | 7 <sup>1</sup> / <sub>4</sub> " | 11 <sup>1</sup> / <sub>4</sub> " | 5" | 3"  | <sup>1</sup> / <sub>16</sub> " | 1 <sup>1</sup> / <sub>4</sub> " NPT | 11.0 lbs |

| MODEL        | ELECTRICAL DATA |            |     |         | HYDRAULIC DATA |             |                 |
|--------------|-----------------|------------|-----|---------|----------------|-------------|-----------------|
|              | Voltage<br>60Hz | P1<br>Watt | Hp  | In<br>A | MAX<br>Flow    | Max<br>Head | Max<br>Pressure |
| VERTY GO 300 | 115v            | 300        | 1/3 | 3.4     | 34 gpm         | 21 ft       | 9 psi           |

# VERTY GO 600

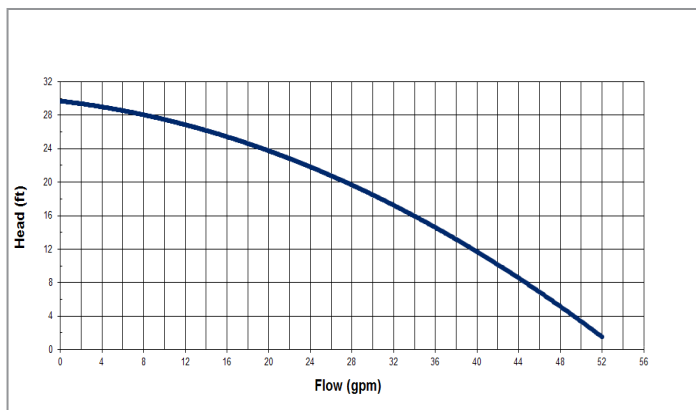
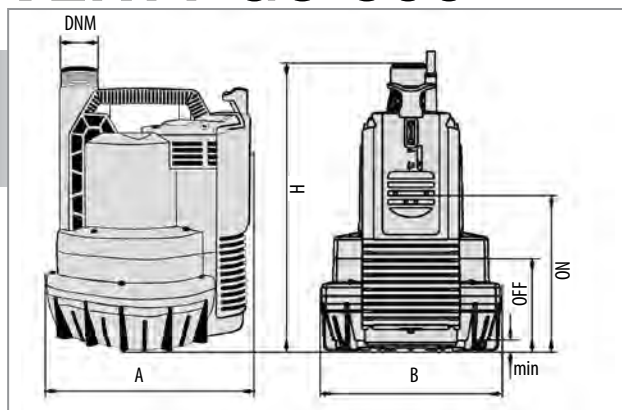

| MODEL        | A                               | B                               | H                                | ON | OFF | MIN                            | DNM                                 | Weight   |
|--------------|---------------------------------|---------------------------------|----------------------------------|----|-----|--------------------------------|-------------------------------------|----------|
| VERTY GO 600 | 8 <sup>3</sup> / <sub>4</sub> " | 7 <sup>1</sup> / <sub>4</sub> " | 11 <sup>1</sup> / <sub>4</sub> " | 5" | 3"  | <sup>1</sup> / <sub>16</sub> " | 1 <sup>1</sup> / <sub>4</sub> " NPT | 14.2 lbs |

| MODEL        | ELECTRICAL DATA |            |     |         | HYDRAULIC DATA |             |                 |
|--------------|-----------------|------------|-----|---------|----------------|-------------|-----------------|
|              | Voltage<br>60Hz | P1<br>Watt | Hp  | In<br>A | MAX<br>Flow    | Max<br>Head | Max<br>Pressure |
| VERTY GO 600 | 115v            | 600        | 1/2 | 6.8     | 52 gpm         | 30 ft       | 13 psi          |



# INSTALLATION DIAGRAM



Minimum suction depth

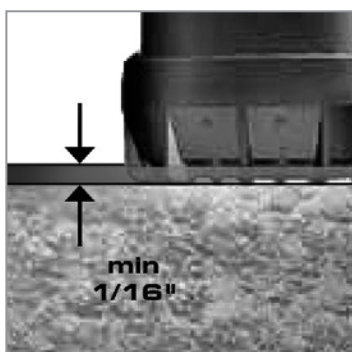

Minimum opening

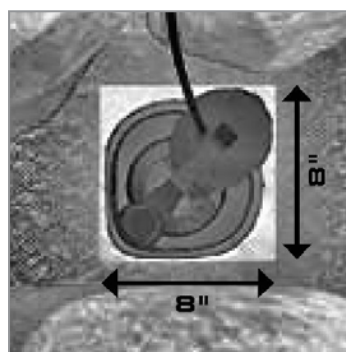

# ECOSUB



## GENERAL DATA

### Applications

Multi-purpose submersible pumps for drainage, emptying, pumping water between containers, to circulate water in garden ponds, create water falls and play water features.

Suitable to pump clear water containing particles with maximum diameter up to 1/2".

- \* Drainage
- \* Emptying sumps
- \* Transferring water between large containers
- \* Circulating water in Garden ponds
- \* Water falls
- \* Fountains

### Constructional features of the pump

Technopolymer pump body.

Technopolymer impeller, diffuser, self-priming disc.

Anti-debris stainless steel strainer.

### Constructional features of the motor

Induction motor, closed and cooled with liquid being pumped

Wear resistant shaft with triple lip seals to ensure a long life.

Built-in thermic overload protection

Capacitor permanently in circuit.

Manufactured according to UL 778 -2010 & CSA 108-1

Motor protection: NEMA6P

Insulation class: F

Cable Length: 16ft

Standard voltage: 115v 60Hz



# TECHNICAL DATA

## MATERIALS

| N° | PARTS*          | MATERIALS                  |
|----|-----------------|----------------------------|
| 1  | PUMP BODY       | PP OMO 30% GF NAT GRADE 6  |
| 2  | TOP BODY        | PP OMO 30% GF NAT GRADE 6  |
| 3  | SUCTION GRID    | PP OMO 30% GF NAT GRADE 18 |
| 4  | IMPELLER        | NORYL                      |
| 5  | 'O' RING        | NBR 70                     |
| 6  | CABLE GLAND     | NBR 70                     |
| 7  | ROTOR SHAFT     | AISI 416 STAINLESS STEEL   |
| 8  | CABLE           | SJTOW                      |
| 9  | PUMP BASE       | PP 30% GF NAT GRADE 6      |
| 10 | TRIPLE LIP SEAL | NBR 70                     |
| 11 | MOTOR CASING    | CAST ALUMINUM              |
| 12 | LOCK NUT        | STAINLESS STEEL A2         |

\* In contact with liquid

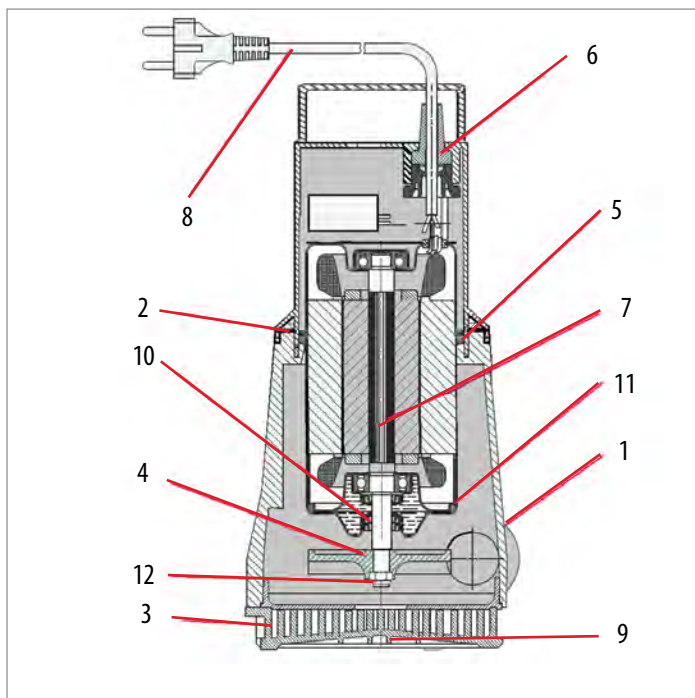

|                              |                                                                                                                                                          |
|------------------------------|----------------------------------------------------------------------------------------------------------------------------------------------------------|
| Operating Range:             | From 1 to 66 gpm with a head up to 30ft (13 psi)                                                                                                         |
| Liquid quality requirements: | clean, free from solids or abrasive substances, non viscous, non aggressive, non crystallized, chemically neutral, close to the characteristics of water |
| Liquid temperature Range:    | From 32°F to 104°F                                                                                                                                       |
| Maximum solids               | 1/2"                                                                                                                                                     |
| Maximum ambient temp.        | 104°F                                                                                                                                                    |
| Maximum operating pressure   | 102 psi                                                                                                                                                  |
| Maximum submersion           | 16 ft                                                                                                                                                    |
| Installation:                | fixed or portable in a vertical position                                                                                                                 |
| Special version on request   | other voltages and/or frequencies                                                                                                                        |

# ECOSUB 400

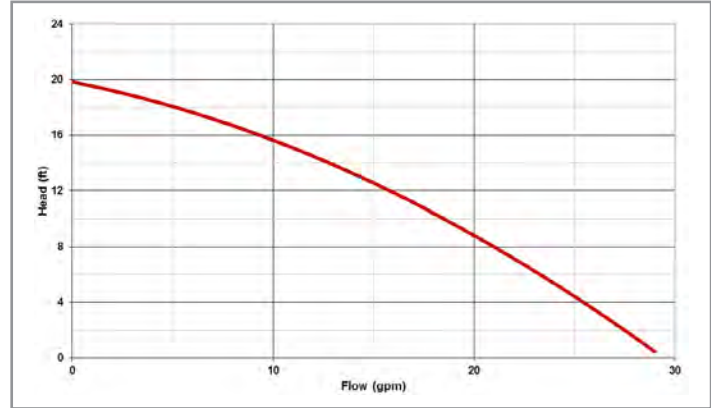
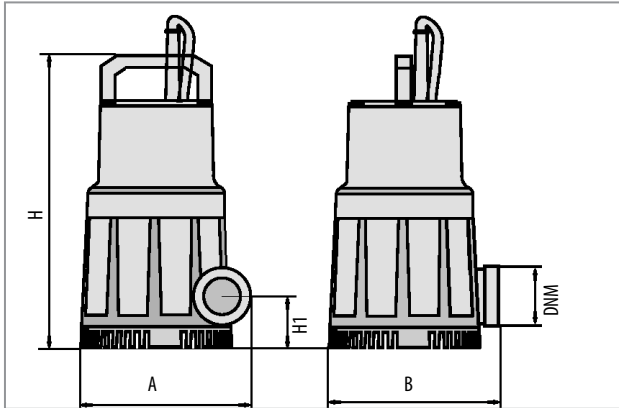

| MODEL      | A      | B      | H       | H1     | DNM        | Weight  |
|------------|--------|--------|---------|--------|------------|---------|
| ECOSUB 400 | 5 1/2" | 6 1/4" | 10 5/8" | 1 3/4" | 1 1/4" NPT | 7.7 lbs |

| MODEL      | ELECTRICAL DATA |            |     |         | HYDRAULIC DATA |             |                 |
|------------|-----------------|------------|-----|---------|----------------|-------------|-----------------|
|            | Voltage<br>60Hz | P1<br>Watt | Hp  | In<br>A | MAX<br>Flow    | Max<br>Head | Max<br>Pressure |
| ECOSUB 400 | 115v            | 220        | 1/4 | 2.0     | 29 gpm         | 20 ft       | 8 psi           |

# ECOSUB 410

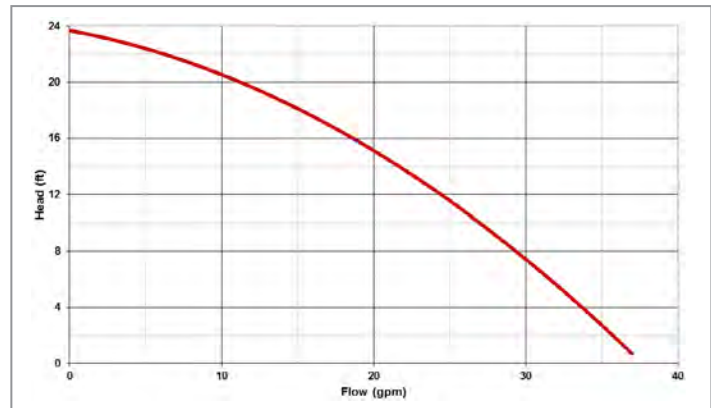
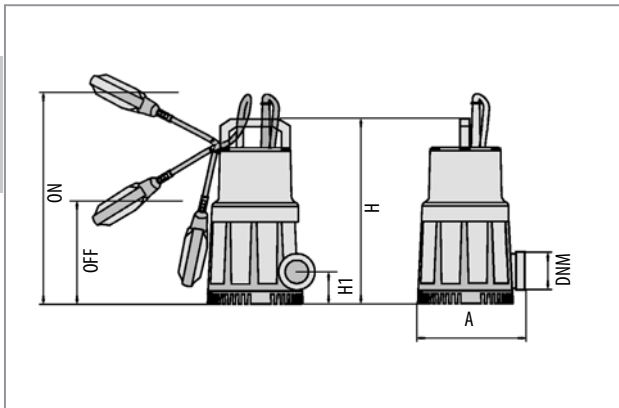

| MODEL        | A      | B      | H       | H1     | OFF | ON  | DNM        | Weight  |
|--------------|--------|--------|---------|--------|-----|-----|------------|---------|
| ECOSUB 410   | 5 1/2" | 6 1/4" | 10 5/8" | 1 3/4" | N/A | N/A | 1 1/4" NPT | 8.2 lbs |
| ECOSUB 410 A | 5 1/2" | 6 1/4" | 10 5/8" | 1 3/4" | 4"  | 10" | 1 1/4" NPT | 8.6 lbs |

| MODEL          | ELECTRICAL DATA |            |     |         | HYDRAULIC DATA |             |                 |
|----------------|-----------------|------------|-----|---------|----------------|-------------|-----------------|
|                | Voltage<br>60Hz | P1<br>Watt | Hp  | In<br>A | MAX<br>Flow    | Max<br>Head | Max<br>Pressure |
| ECOSUB 410 & A | 115v            | 370        | 1/3 | 3.0     | 37 gpm         | 23 ft       | 10 psi          |

# ECOSUB 420

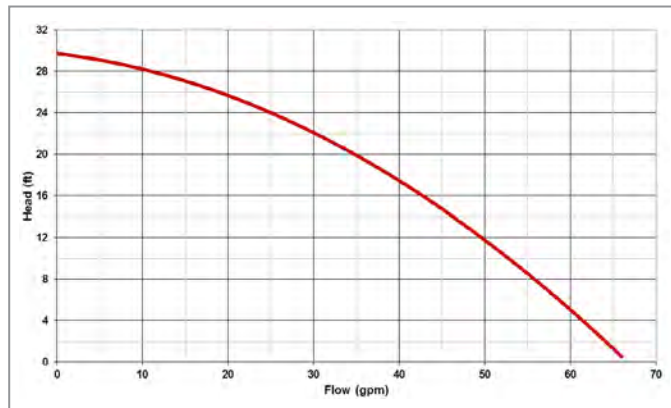
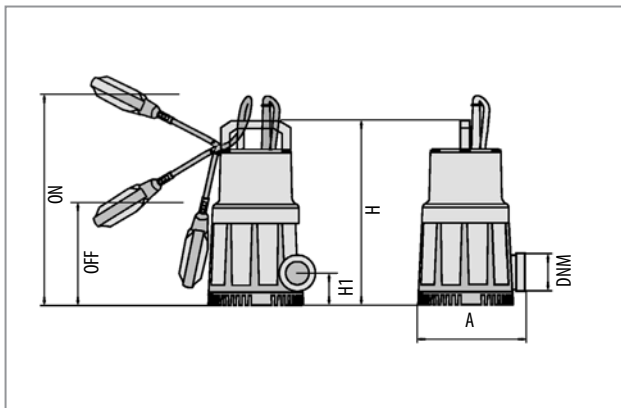

| MODEL        | A      | B      | H   | H1     | OFF | ON  | DNM        | Weight   |
|--------------|--------|--------|-----|--------|-----|-----|------------|----------|
| ECOSUB 420   | 5 1/2" | 6 1/4" | 12" | 1 3/4" | N/A | N/A | 1 1/4" NPT | 11.4 lbs |
| ECOSUB 420 A | 5 1/2" | 6 1/4" | 12" | 1 3/4" | 11" | 4"  | 1 1/4" NPT | 12.0 lbs |

| MODEL          | ELECTRICAL DATA |                |     |         | HYDRAULIC DATA |             |                 |
|----------------|-----------------|----------------|-----|---------|----------------|-------------|-----------------|
|                | Voltage<br>60Hz | P1<br>kW    Hp |     | In<br>A | MAX<br>Flow    | Max<br>Head | Max<br>Pressure |
| ECOSUB 420 & A | 115v            | 750            | 1/2 | 7.1     | 66 gpm         | 30 ft       | 13 psi          |

# BVP & BVP Max



## GENERAL DATA

### Applications

Multi-purpose submersible pumps for drainage, emptying, pumping water between containers, to circulate water in garden ponds, create water falls and play water features.

Suitable to pump clear water containing particles with maximum diameter up to 1"1/2.

- \* Drainage
- \* Emptying sumps
- \* Transferring water between large containers
- \* Circulating water in Garden ponds
- \* Water falls, Fountains & Water features

### Constructional features of the pump

Technopolymer pump body.

Technopolymer impeller, diffuser, self-priming disc.

Anti-debris stainless steel strainer.

### Constructional features of the motor

Induction motor, closed and cooled with liquid being pumped

Wear resistant shaft with triple lip seals to ensure a long life.

Built-in thermic overload protection

Capacitor permanently in circuit.

Manufactured according to UL 778 -2010 & CSA 108-1

Motor protection: NEMA6P

Insulation class: F

Cable Length: 16ft

Standard voltage: 115v 60Hz

# TECHNICAL DATA

## MATERIALS

| N° | PARTS*             | MATERIALS                         |
|----|--------------------|-----------------------------------|
| 1  | PUMP BODY          | PP 30% GF NAT GRADE 6             |
| 2  | TOP BODY           | PP 30% GF NAT GRADE 6             |
| 3  | PUMP BASE          | PP 30% GF NAT GRADE 6             |
| 4  | IMPELLER           | NYLON                             |
| 5  | 'O' RING           | NBR 70                            |
| 6  | SPACER BODY        | PP 30% GF NAT GRADE 6             |
| 7  | ROTOR SHAFT        | AISI 416 STAINLESS STEEL QUENCHED |
| 8  | UPPER MOTOR CASING | CAST ALUMINUM                     |
| 9  | 'O' RING           | NBR 70                            |
| 10 | TRIPLE LIP SEAL    | NBR 70                            |
| 11 | LOWER MOTOR CASING | CAST ALUMINUM                     |
| 12 | LOCK NUT           | STAINLESS STEEL A2                |

\* In contact with liquid

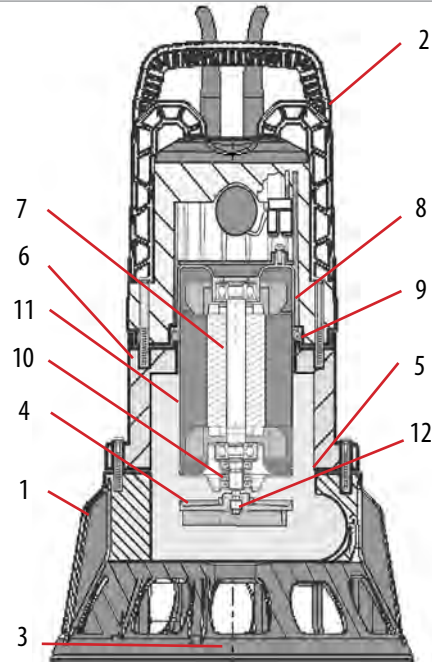

|                              |                                                                                                                                                          |
|------------------------------|----------------------------------------------------------------------------------------------------------------------------------------------------------|
| Operating Range:             | From 1 to 110 gpm with a head up to 39ft (17 psi)                                                                                                        |
| Liquid quality requirements: | clean, free from solids or abrasive substances, non viscous, non aggressive, non crystallized, chemically neutral, close to the characteristics of water |
| Liquid temperature Range:    | From 32°F to 104°F                                                                                                                                       |
| Maximum solids               | 1/2"                                                                                                                                                     |
| Maximum ambient temp.        | 104°F                                                                                                                                                    |
| Maximum operating pressure   | 102 psi                                                                                                                                                  |
| Maximum submersion           |                                                                                                                                                          |
| Installation:                | fixed or portable in a vertical position                                                                                                                 |
| Special version on request   | other voltages and/or frequencies                                                                                                                        |

# BVP

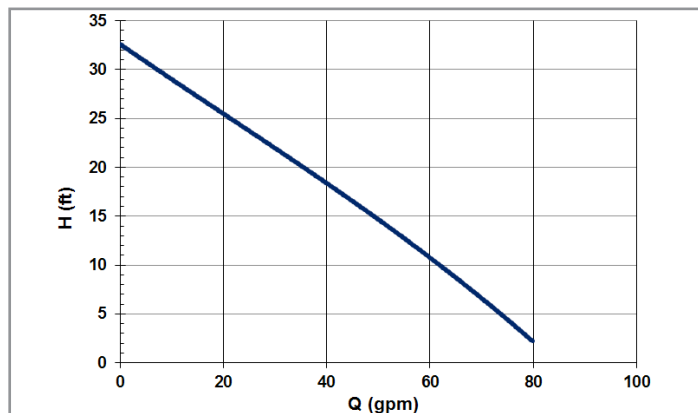
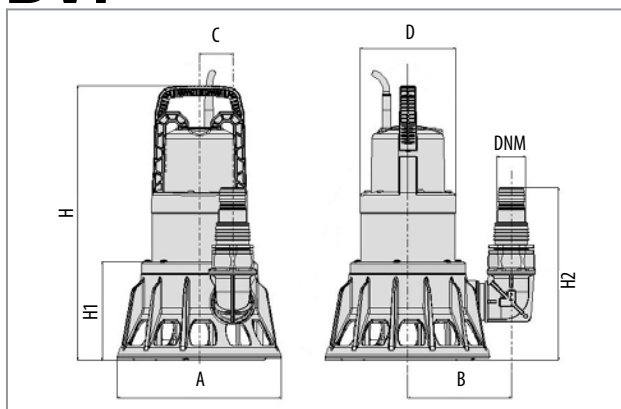

| MODEL | A      | B      | C      | D      | H       | H1     | H2     | DNM        | Weight   |
|-------|--------|--------|--------|--------|---------|--------|--------|------------|----------|
| BVP   | 9 1/2" | 5 7/8" | 1 7/8" | 5 1/2" | 15 3/4" | 5 5/8" | 9 7/8" | 1 1/2" NPT | 17.5 lbs |

| MODEL | ELECTRICAL DATA |            |     |         | HYDRAULIC DATA |             |                 |
|-------|-----------------|------------|-----|---------|----------------|-------------|-----------------|
|       | Voltage<br>60Hz | P1<br>Watt | Hp  | In<br>A | MAX<br>Flow    | Max<br>Head | Max<br>Pressure |
| BVP   | 115v            | 1000       | 3/4 | 10      | 88 gpm         | 36 ft       | 16 psi          |

# BVP Auto

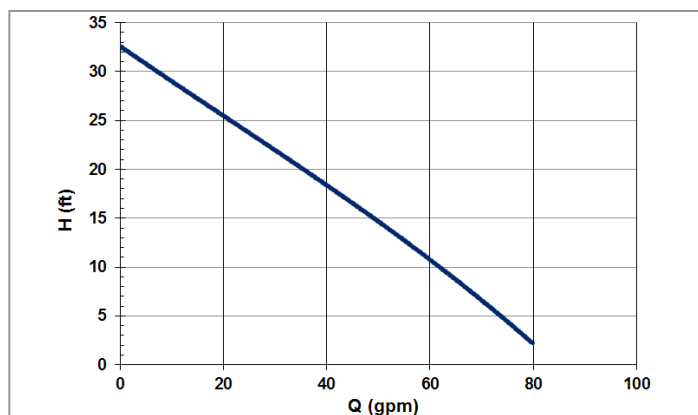
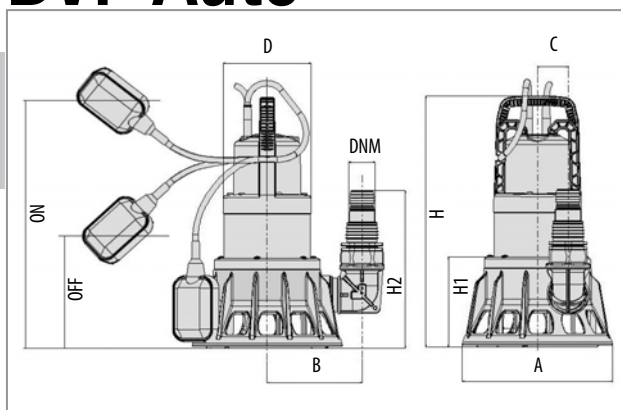

| MODEL    | A      | B      | C      | D      | H       | H1     | H2     | OFF | ON  | DNM        | Weight   |
|----------|--------|--------|--------|--------|---------|--------|--------|-----|-----|------------|----------|
| BVP Auto | 9 1/2" | 5 7/8" | 1 7/8" | 5 1/2" | 15 3/4" | 5 5/8" | 9 7/8" | 7"  | 14" | 1 1/2" NPT | 17.7 lbs |

| MODEL    | ELECTRICAL DATA |            |     |         | HYDRAULIC DATA |             |                 |
|----------|-----------------|------------|-----|---------|----------------|-------------|-----------------|
|          | Voltage<br>60Hz | P1<br>Watt | Hp  | In<br>A | MAX<br>Flow    | Max<br>Head | Max<br>Pressure |
| BVP Auto | 115v            | 1000       | 3/4 | 10      | 88 gpm         | 36 ft       | 16 psi          |

# BVP Max

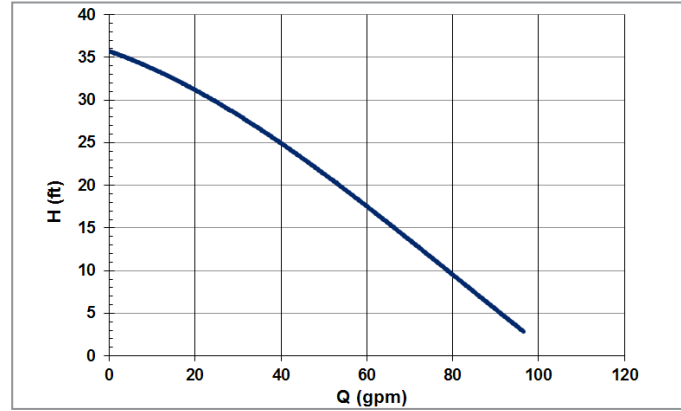
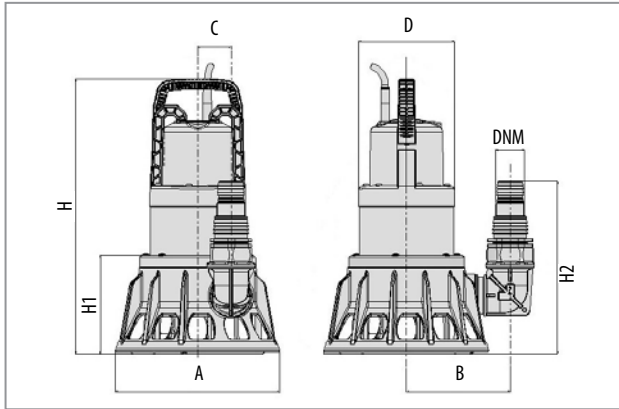

| MODEL | A      | B      | C      | D      | H       | H1     | H2     | DNM        | Weight   |
|-------|--------|--------|--------|--------|---------|--------|--------|------------|----------|
| BVP   | 9 1/2" | 5 7/8" | 1 7/8" | 5 1/2" | 15 3/4" | 5 5/8" | 9 7/8" | 1 1/2" NPT | 17.7 lbs |

| MODEL   | ELECTRICAL DATA |                |   |         | HYDRAULIC DATA |             |                 |
|---------|-----------------|----------------|---|---------|----------------|-------------|-----------------|
|         | Voltage<br>60Hz | P1<br>kW    Hp |   | In<br>A | MAX<br>Flow    | Max<br>Head | Max<br>Pressure |
| BVP Max | 115v            | 1100           | 1 | 11.2    | 111 gpm        | 39 ft       | 17 psi          |

# ECOVORT



## GENERAL DATA

### Applications

Multi-purpose submersible pumps for drainage, emptying, pumping water between containers, to circulate water in garden ponds, create water falls and play water features.

Suitable to pump clear water containing particles with maximum diameter up to 1"1/4.

- \* Drainage
- \* Emptying sumps
- \* Transferring water between large containers
- \* Circulating water in Garden ponds
- \* Water falls
- \* Fountains

### Constructional features of the pump

Technopolymer pump body.

Technopolymer impeller, diffuser, self-priming disc.

Anti-debris stainless steel strainer.

### Constructional features of the motor

Induction motor, closed and cooled with liquid being pumped

Wear resistant shaft with triple lip seals to ensure a long life.

Built-in thermic overload protection

Capacitor permanently in circuit.

Manufactured according to UL 778 -2010 & CSA 108-1

Motor protection: NEMA6P

Insulation class: F

Cable Length: 16ft

Standard voltage: 115v 60Hz



# TECHNICAL DATA

## MATERIALS

| N° | PARTS*          | MATERIALS                |
|----|-----------------|--------------------------|
| 1  | PUMP BODY       | PP 30% GF NAT GRADE 6    |
| 2  | TOP BODY        | PP 30% GF NAT GRADE 5    |
| 3  | PUMP BASE       | PP 30% GF NAT GRADE 18   |
| 4  | IMPELLER        | NYLON                    |
| 5  | 'O' RING        | NBR 70                   |
| 6  | CABLE GLAND     | NBR 70                   |
| 7  | ROTOR SHAFT     | AISI 416 STAINLESS STEEL |
| 8  | CABLE           | SJTOW                    |
| 9  | PRESSURE DISC   | PP OMO 30                |
| 10 | TRIPLE LIP SEAL | NBR 70                   |
| 11 | MOTOR CASING    | CAST ALUMINUM            |
| 12 | LOCK NUT        | STAINLESS STEEL A2       |

\* In contact with liquid

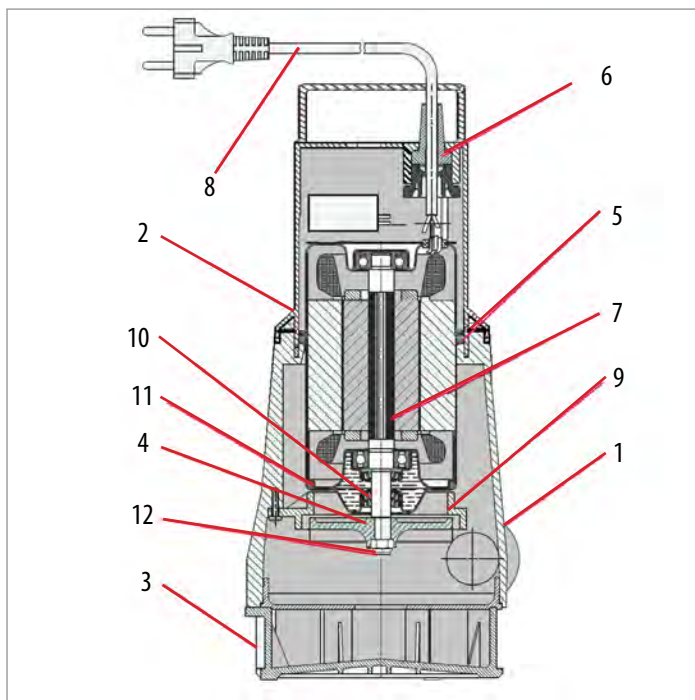

|                              |                                                                                                                                                          |
|------------------------------|----------------------------------------------------------------------------------------------------------------------------------------------------------|
| Operating Range:             | From 1 to 60 gpm with a head up to 28ft (12 psi)                                                                                                         |
| Liquid quality requirements: | clean, free from solids or abrasive substances, non viscous, non aggressive, non crystallized, chemically neutral, close to the characteristics of water |
| Liquid temperature Range:    | From 32°F to 95°F                                                                                                                                        |
| Maximum solids               | 1/2"                                                                                                                                                     |
| Maximum ambient temp.        | 104°F                                                                                                                                                    |
| Maximum operating pressure   | 102 psi                                                                                                                                                  |
| Maximum submersion           | 16 ft                                                                                                                                                    |
| Installation:                | fixed or portable in a vertical position                                                                                                                 |
| Special version on request   | other voltages and/or frequencies                                                                                                                        |

# ECOVORT 510

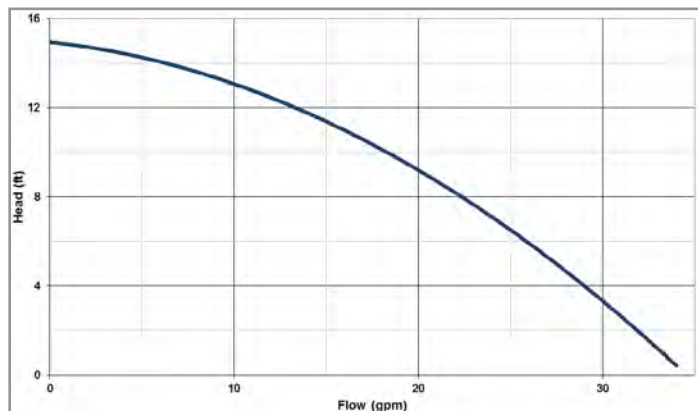
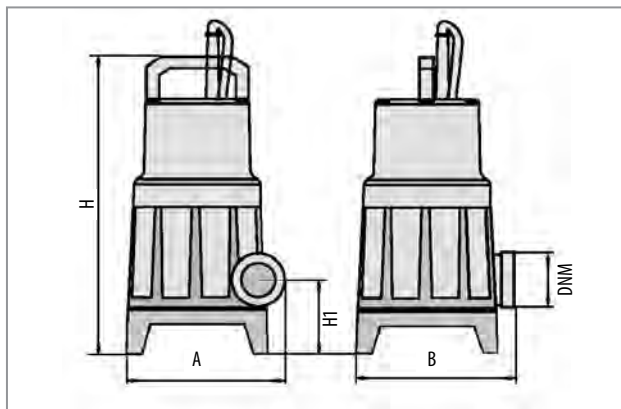

| MODEL       | A      | B      | H       | H1     | DNM        | Weight  |
|-------------|--------|--------|---------|--------|------------|---------|
| ECOVORT 510 | 5 1/2" | 6 1/4" | 13 1/8" | 2 3/4" | 1 1/4" NPT | 8.0 lbs |

| MODEL       | ELECTRICAL DATA |            |     |         | HYDRAULIC DATA |             |                 |
|-------------|-----------------|------------|-----|---------|----------------|-------------|-----------------|
|             | Voltage<br>60Hz | P1<br>Watt | Hp  | In<br>A | MAX<br>Flow    | Max<br>Head | Max<br>Pressure |
| ECOVORT 510 | 115v            | 330        | 1/3 | 3.0     | 34 gpm         | 15 ft       | 6 psi           |

# ECOVORT 510-A

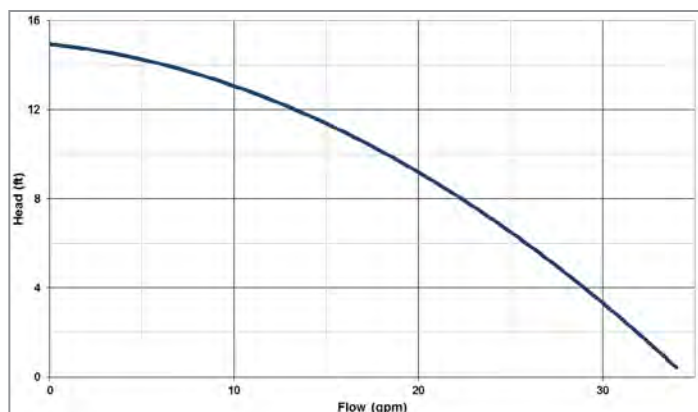
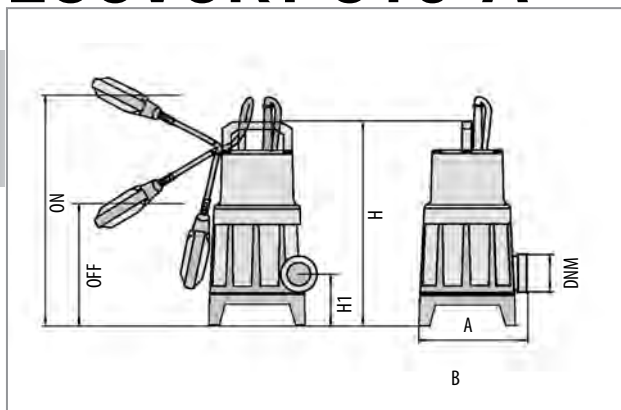

| MODEL      | A      | B      | H       | H1     | OFF    | ON  | DNM        | Weight  |
|------------|--------|--------|---------|--------|--------|-----|------------|---------|
| ECOSUB 420 | 5 1/2" | 6 1/4" | 13 1/8" | 2 3/4" | 6 1/2" | 15" | 1 1/4" NPT | 8.4 lbs |

| MODEL         | ELECTRICAL DATA |            |     |         | HYDRAULIC DATA |             |                 |
|---------------|-----------------|------------|-----|---------|----------------|-------------|-----------------|
|               | Voltage<br>60Hz | P1<br>Watt | Hp  | In<br>A | MAX<br>Flow    | Max<br>Head | Max<br>Pressure |
| ECOVORT 510-A | 115v            | 330        | 1/3 | 3.0     | 34 gpm         | 15 ft       | 6 psi           |

# ECOVORT 520

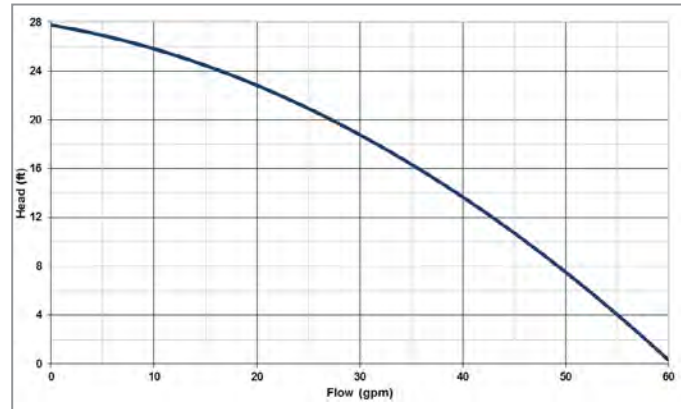
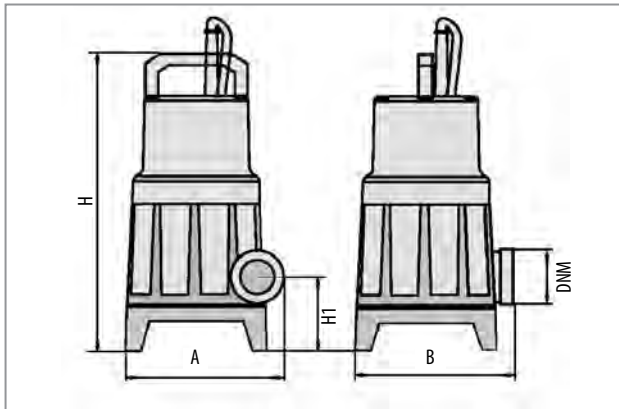

| MODEL       | A      | B      | H       | H1     | DNM        | Weight   |
|-------------|--------|--------|---------|--------|------------|----------|
| ECOVORT 520 | 5 1/2" | 6 1/4" | 13 1/8" | 2 3/4" | 1 1/4" NPT | 11.5 lbs |

| MODEL       | ELECTRICAL DATA |          |          |         | HYDRAULIC DATA |             |                 |
|-------------|-----------------|----------|----------|---------|----------------|-------------|-----------------|
|             | Voltage<br>60Hz | P1<br>kW | P1<br>Hp | In<br>A | MAX<br>Flow    | Max<br>Head | Max<br>Pressure |
| ECOVORT 520 | 115v            | 650      | 1/2      | 7.1     | 60 gpm         | 28 ft       | 12 psi          |

# ECOVORT 520-A

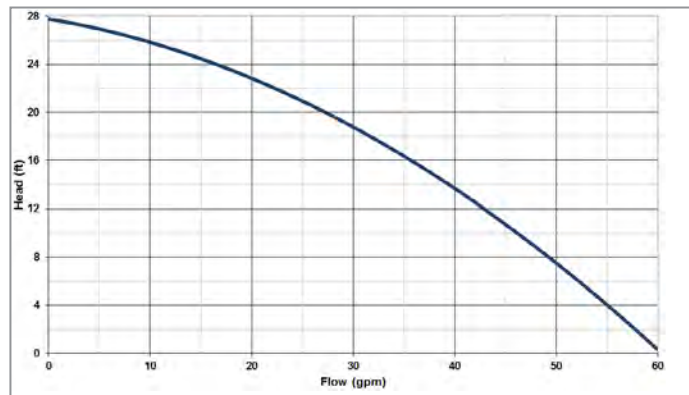
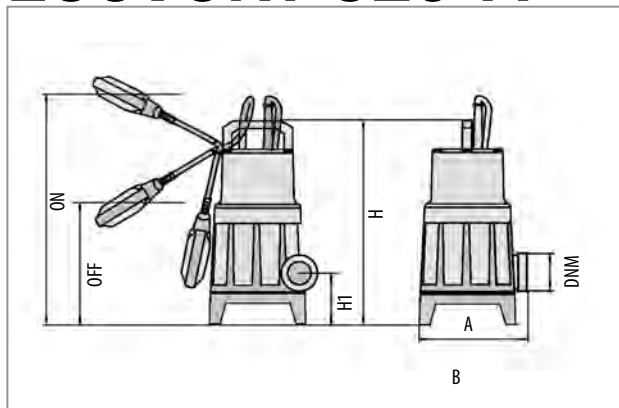

| MODEL      | A      | B      | H       | H1     | OFF    | ON  | DNM        | Weight   |
|------------|--------|--------|---------|--------|--------|-----|------------|----------|
| ECOSUB 420 | 5 1/2" | 6 1/4" | 13 1/8" | 2 3/4" | 6 1/2" | 15" | 1 1/4" NPT | 12.0 lbs |

| MODEL         | ELECTRICAL DATA |            |          |         | HYDRAULIC DATA |             |                 |
|---------------|-----------------|------------|----------|---------|----------------|-------------|-----------------|
|               | Voltage<br>60Hz | P1<br>Watt | P1<br>Hp | In<br>A | MAX<br>Flow    | Max<br>Head | Max<br>Pressure |
| ECOVORT 520-A | 115v            | 650        | 1/2      | 7.1     | 60 gpm         | 28 ft       | 12 psi          |

# ECOTRONIC



## GENERAL DATA

### Applications

ECOTRONIC 110, 120 & 130 ECOJET self priming single impeller pump fitted with the Hydrotronic pump control system

ECOTRONIC 230, 240 & 250 ECOPLUS self priming multistage pump (with 2,3 or 4 impellers) fitted with the Hydrotronic pump control system to supply water for systems including

Pressure Boosting

- \* Residential Homes
- \* Farming Applications
- \* Residential Irrigation
- \* Garden Irrigation Drip/Low Flow
- \* Hydroponics
- \* Rain Water Harvesting
- \* Water Supply from Shallow Wells

F version supplied with 5" filter housing and filter cartridge

### Constructional features of the pump .

Technopolymer pump body and motor support.

Carbon/ceramic mechanical seal.

Technopolymer impeller, diffuser, venturi and nozzle in ECOJET

Technopolymer impeller, diffuser, self-priming disc in ECOPLUS

### Construction of the motor

Induction motor, closed and cooled with external ventilation.

Rotor mounted on oversized greased sealed-for-life ball bearings to ensure silent running and a long life.

Built-in thermal and current overload protection on ECOTRONIC 110 & 230

Built-in thermal and resettable overload protection on ECOTRONIC 120, 130, 240 & 250

Motor protection: NEMA 3

Insulation class: F

Standard voltage: 115v 60Hz

# TECHNICAL DATA

## MATERIALS

| N° | PARTS*           | MATERIALS                                              |
|----|------------------|--------------------------------------------------------|
| 1  | PUMP             | SEE ECOJET 110, 120 , 130<br>SEE ECOPLUS 230, 240, 250 |
| 2  | NON-RETURN VALVE | TECHNOPOLYMER                                          |
| 3  | VALVE BODY       | TECHNOPOLYMER                                          |
| 4  | FLOW SENSOR      | TECHNOPOLYMER                                          |
| 5  | FLOW SENSOR      | TECHNOPOLYMER                                          |
| 6  | OR GASKET        | NBR                                                    |
| 7  | OR GASKET        | NBR                                                    |
| 15 | BODY             | TECHNOPOLYMER                                          |

\* In contact with liquid

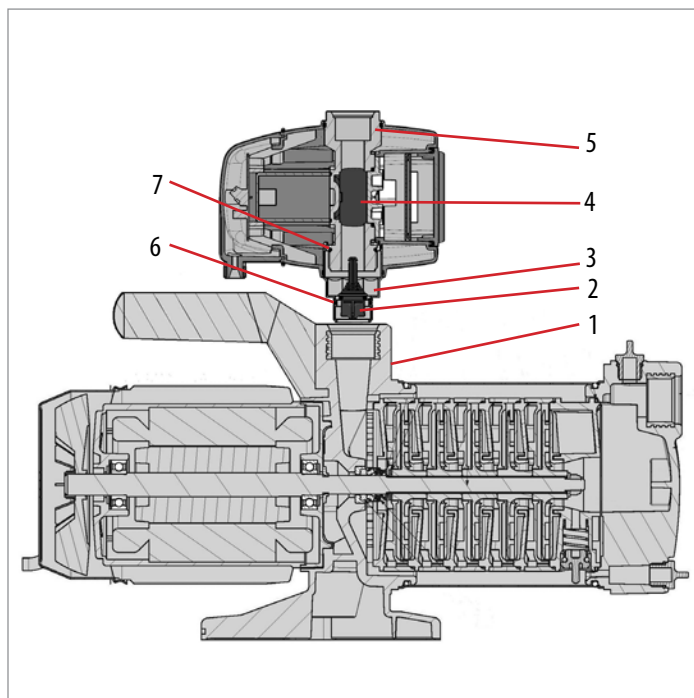

|                              |                                                                                                                                                                |
|------------------------------|----------------------------------------------------------------------------------------------------------------------------------------------------------------|
| Operating Range:             | ECOTRONIC 110 to 130 From 1 to 21gpm with a head up to 164ft ( 71 psi )<br>ECOTRONIC 230 to 250 From 1 to 27gpm with a head up to 197ft ( 85 psi )             |
| Liquid quality requirements: | clean, free from solids or abrasive substances,<br>non viscous, non aggressive, non crystallized, chemically<br>neutral, close to the characteristics of water |
| Liquid temperature Range:    | From 32°F to 104°F                                                                                                                                             |
| Maximum suction depth        | 26 ft                                                                                                                                                          |
| Maximum ambient temp.        | 104°F                                                                                                                                                          |
| Maximum operating pressure   | 116 psi                                                                                                                                                        |
| Installation:                | fixed or portable in a horizontal position                                                                                                                     |
| Special version on request   | other voltages and/or frequencies                                                                                                                              |

# ECOTRONIC 110

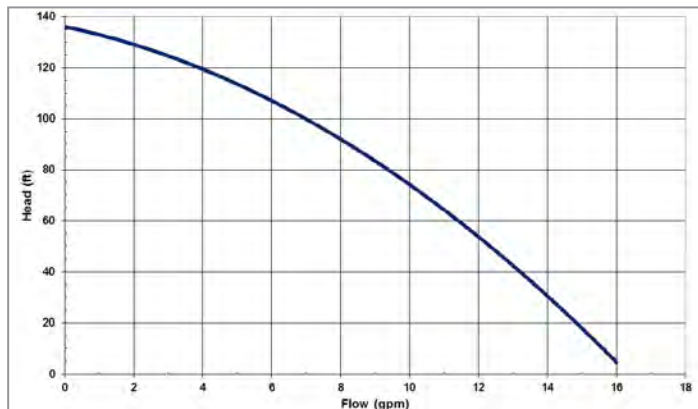
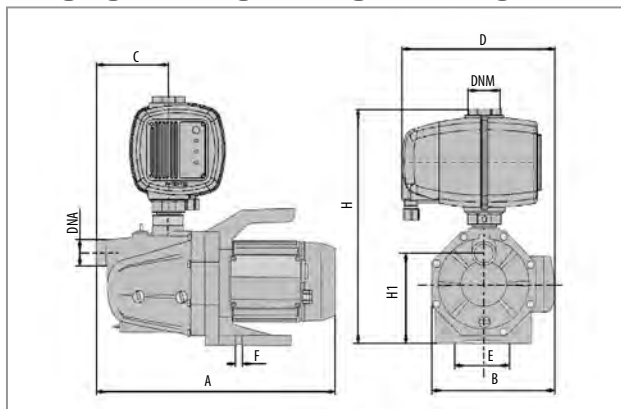

| MODEL         | A                                | B                               | C                               | D                               | E                               | F                             | H                                | H1                              | DNA    | DNM    | Weight   |
|---------------|----------------------------------|---------------------------------|---------------------------------|---------------------------------|---------------------------------|-------------------------------|----------------------------------|---------------------------------|--------|--------|----------|
| ECOTRONIC 110 | 15 <sup>3</sup> / <sub>4</sub> " | 8 <sup>3</sup> / <sub>4</sub> " | 4 <sup>5</sup> / <sub>8</sub> " | 9 <sup>1</sup> / <sub>2</sub> " | 5 <sup>3</sup> / <sub>4</sub> " | <sup>3</sup> / <sub>8</sub> " | 15 <sup>1</sup> / <sub>2</sub> " | 6 <sup>1</sup> / <sub>2</sub> " | 1" NPT | 1" NPT | 26.4 lbs |

| MODEL         | ELECTRICAL DATA |                  |     |         | HYDRAULIC DATA    |             |             |                 |
|---------------|-----------------|------------------|-----|---------|-------------------|-------------|-------------|-----------------|
|               | Voltage<br>60Hz | P1<br>Watt    Hp |     | In<br>A | Start<br>Pressure | MAX<br>Flow | Max<br>Head | Max<br>Pressure |
| ECOTRONIC 110 | 115v            | 800              | 1/2 | 8.0     | 23 psi            | 16 gpm      | 138 ft      | 60 psi          |

# ECOTRONIC 120 F

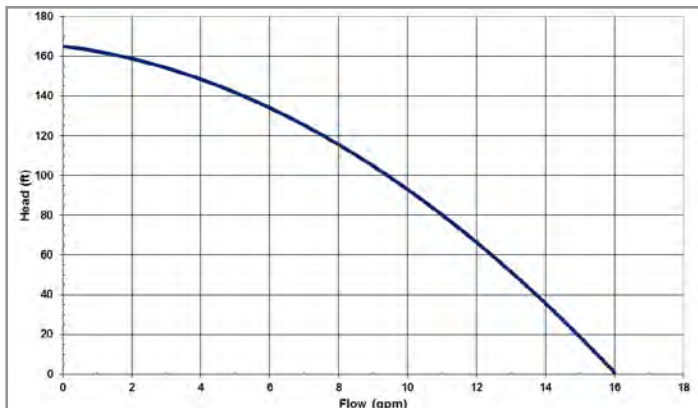
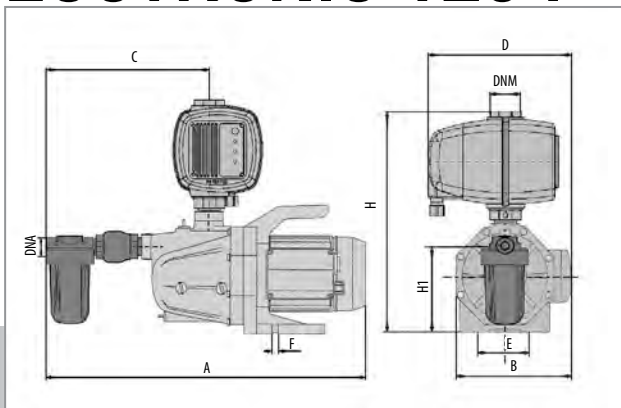

| MODEL           | A                                | B                               | C                                | D                               | E                               | F                             | H                                | H1                              | DNA    | DNM    | Weight   |
|-----------------|----------------------------------|---------------------------------|----------------------------------|---------------------------------|---------------------------------|-------------------------------|----------------------------------|---------------------------------|--------|--------|----------|
| ECOTRONIC 120 F | 22 <sup>3</sup> / <sub>4</sub> " | 8 <sup>3</sup> / <sub>4</sub> " | 11 <sup>5</sup> / <sub>8</sub> " | 9 <sup>1</sup> / <sub>2</sub> " | 5 <sup>3</sup> / <sub>4</sub> " | <sup>3</sup> / <sub>8</sub> " | 15 <sup>1</sup> / <sub>2</sub> " | 6 <sup>1</sup> / <sub>2</sub> " | 1" NPT | 1" NPT | 29.5 lbs |

| MODEL           | ELECTRICAL DATA |                  |     |         | HYDRAULIC DATA    |             |             |                 |
|-----------------|-----------------|------------------|-----|---------|-------------------|-------------|-------------|-----------------|
|                 | Voltage<br>60Hz | P1<br>Watt    Hp |     | In<br>A | Start<br>Pressure | MAX<br>Flow | Max<br>Head | Max<br>Pressure |
| ECOTRONIC 120 F | 115v            | 1000             | 3/4 | 10.0    | 23 psi            | 16 gpm      | 164 ft      | 71 psi          |

\* F version supplied with a 5" filter housing and sediment filter housing.

# ECOTRONIC 130

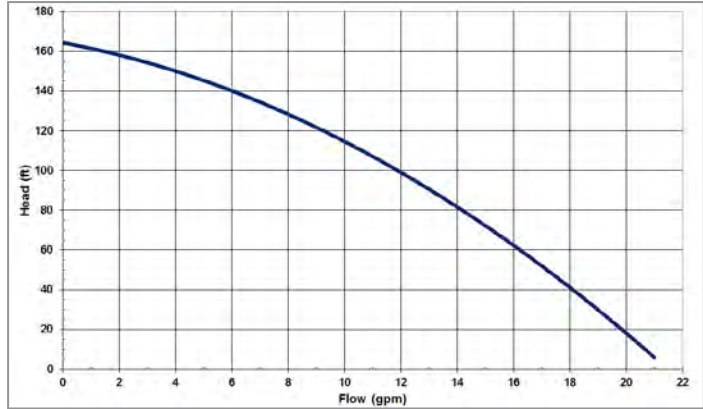
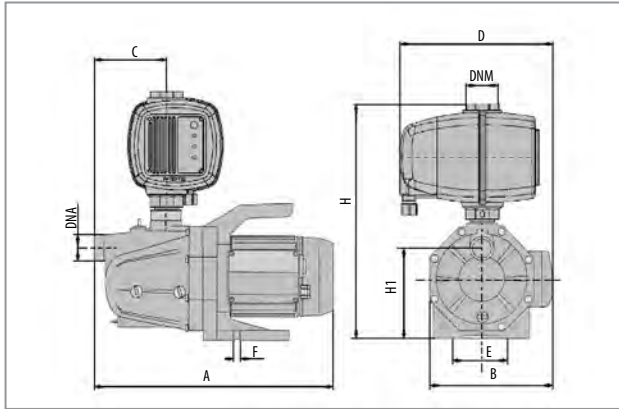

| MODEL         | A                                | B                               | C                               | D                               | E                               | F                             | H                                | H1                              | DNA    | DNM     | Weight   |
|---------------|----------------------------------|---------------------------------|---------------------------------|---------------------------------|---------------------------------|-------------------------------|----------------------------------|---------------------------------|--------|---------|----------|
| ECOTRONIC 130 | 15 <sup>3</sup> / <sub>4</sub> " | 8 <sup>3</sup> / <sub>4</sub> " | 4 <sup>5</sup> / <sub>8</sub> " | 9 <sup>1</sup> / <sub>2</sub> " | 5 <sup>3</sup> / <sub>4</sub> " | <sup>3</sup> / <sub>8</sub> " | 15 <sup>1</sup> / <sub>2</sub> " | 6 <sup>1</sup> / <sub>2</sub> " | 1" NPT | 1 " NPT | 27.2 lbs |

| MODEL         | ELECTRICAL DATA |      |    |         | HYDRAULIC DATA    |             |             |                 |
|---------------|-----------------|------|----|---------|-------------------|-------------|-------------|-----------------|
|               | Voltage<br>60Hz | P1   |    | In<br>A | Start<br>Pressure | MAX<br>Flow | Max<br>Head | Max<br>Pressure |
| ECOTRONIC 130 | 115v            | Watt | Hp | 13.0    | 23 psi            | 21 gpm      | 164 ft      | 71 psi          |



# ECOTRONIC 230

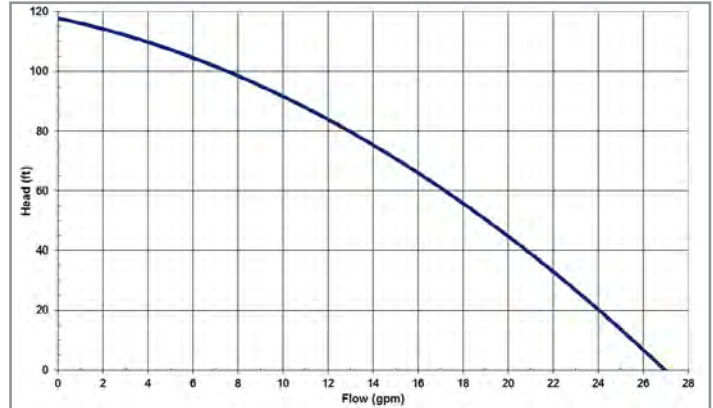
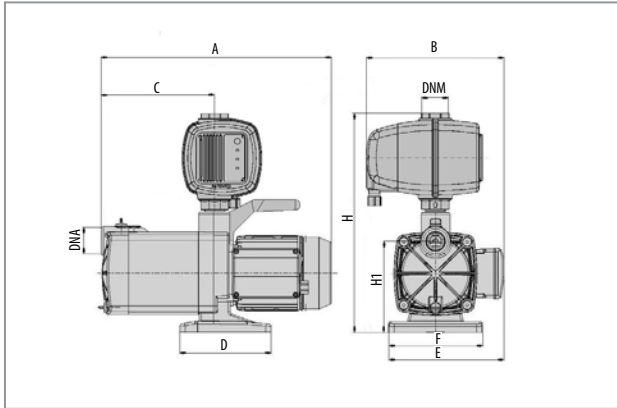

| MODEL         | A       | B      | C      | D      | E      | F      | H       | H1     | DNA    | DNM    | Weight   |
|---------------|---------|--------|--------|--------|--------|--------|---------|--------|--------|--------|----------|
| ECOTRONIC 230 | 16 1/8" | 9 1/2" | 7 1/8" | 6 3/4" | 8 1/2" | 5 5/8" | 15 3/8" | 5 5/8" | 1" NPT | 1" NPT | 26.4 lbs |

| MODEL         | ELECTRICAL DATA |                  |     |         | HYDRAULIC DATA    |             |             |                 |
|---------------|-----------------|------------------|-----|---------|-------------------|-------------|-------------|-----------------|
|               | Voltage<br>60Hz | P1<br>Watt    Hp |     | In<br>A | Start<br>Pressure | MAX<br>Flow | Max<br>Head | Max<br>Pressure |
| ECOTRONIC 230 | 115v            | 800              | 1/2 | 7.5     | 23 psi            | 27 gpm      | 118 ft      | 51 psi          |

# ECOTRONIC 240 F

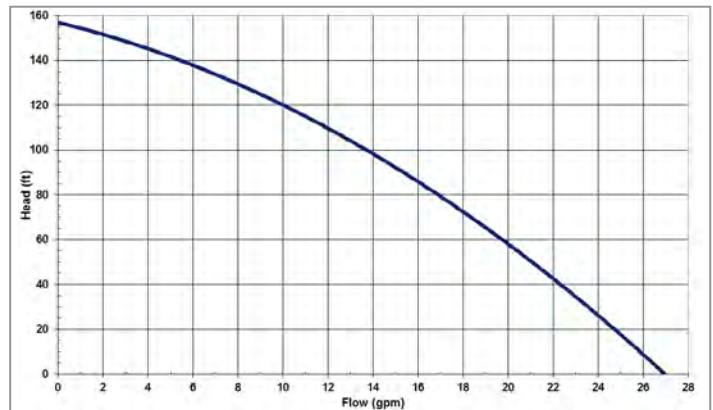
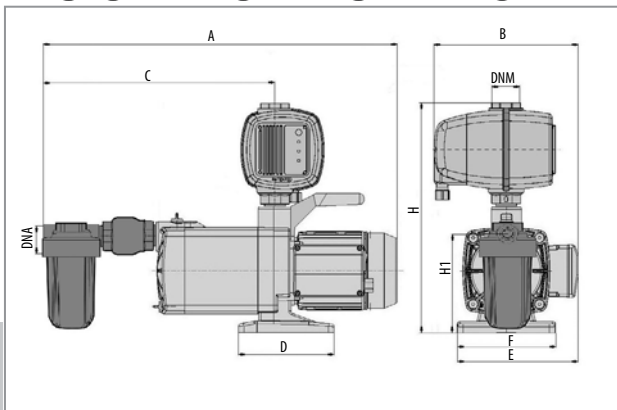

| MODEL           | A   | B      | C       | D      | E      | F      | H       | H1     | DNA    | DNM    | Weight   |
|-----------------|-----|--------|---------|--------|--------|--------|---------|--------|--------|--------|----------|
| ECOTRONIC 240 F | 24" | 9 1/2" | 15 1/4" | 6 3/4" | 8 1/2" | 5 5/8" | 15 3/8" | 5 5/8" | 1" NPT | 1" NPT | 29.5 lbs |

| MODEL           | ELECTRICAL DATA |                  |     |         | HYDRAULIC DATA    |             |             |                 |
|-----------------|-----------------|------------------|-----|---------|-------------------|-------------|-------------|-----------------|
|                 | Voltage<br>60Hz | P1<br>Watt    Hp |     | In<br>A | Start<br>Pressure | MAX<br>Flow | Max<br>Head | Max<br>Pressure |
| ECOTRONIC 240 F | 115v            | 1000             | 3/4 | 10.0    | 23 psi            | 27 gpm      | 157 ft      | 68 psi          |

\* F version supplied with a 5" filter housing and sediment filter housing.



# ECOTRONIC 250

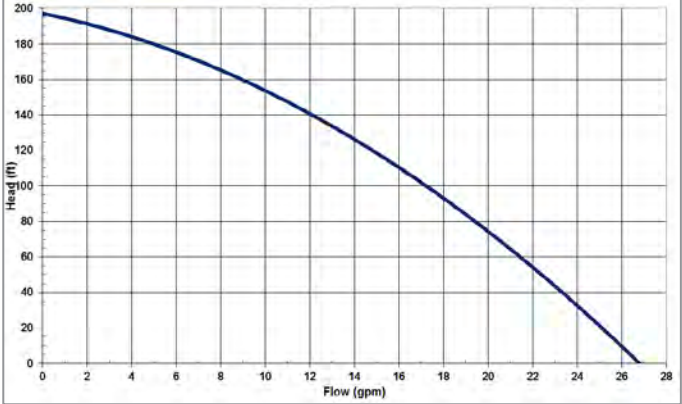
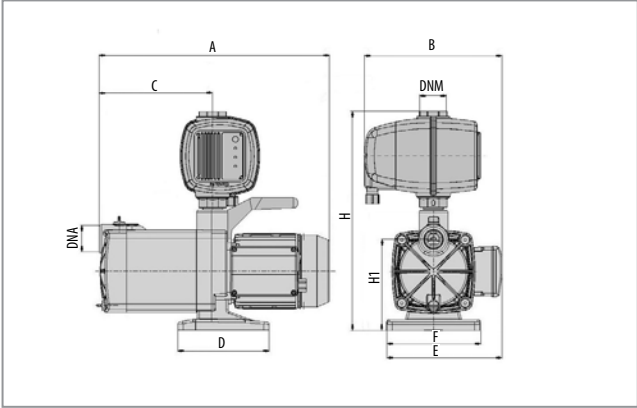

| MODEL         | A    | B       | C       | D       | E       | F       | H        | H1      | DNA    | DNM     | Weight   |
|---------------|------|---------|---------|---------|---------|---------|----------|---------|--------|---------|----------|
| ECOTRONIC 250 | 18 " | 9 1/2 " | 9 1/4 " | 6 3/4 " | 8 1/2 " | 5 5/8 " | 15 3/8 " | 5 5/8 " | 1" NPT | 1 " NPT | 27.2 lbs |

| MODEL         | ELECTRICAL DATA |      |    |         | HYDRAULIC DATA    |             |             |                 |
|---------------|-----------------|------|----|---------|-------------------|-------------|-------------|-----------------|
|               | Voltage<br>60Hz | P1   |    | In<br>A | Start<br>Pressure | MAX<br>Flow | Max<br>Head | Max<br>Pressure |
| ECOTRONIC 250 | 115v            | Watt | Hp | 13.0    | 23 psi            | 27 gpm      | 197 ft      | 85 psi          |
|               |                 | 1200 | 1  |         |                   |             |             |                 |

# ECOMATIC



## GENERAL DATA

### Applications

ECOMATIC 110, 120 & 130 ECOJET self priming single impeller pump fitted with a 4 gal. pressure tank, switch and gauge to switch the pump on and off depending to the flow demand to supply water for systems including

- Pressure Boosting
- \* Residential Homes
- \* Farming Applications
- \* Resedential Irrigation
- \* Garden Irrigation Drip/Low Flow
- \* Hydroponics
- \* Rain Water Harvesting
- \* Water Supply from Shallow Wells

F version supplied with 5" filter housing and filter cartridge

### Constructional features of the pump .

Technopolymer pump body and motor support.

Carbon/ceramic mechanical seal.

Technopolymer impeller, diffuser, venturi and nozzle in ECOJET

### Construction of the motor

Induction motor, closed and cooled with external ventilation.

Rotor mounted on oversized greased sealed-for-life ball bearings to ensure silent running and a long life.

Built-in thermal and current overload protection on ECOMATIC 110

Bult-in thermal and resetable overload protection on ECOMATIC 120 & 130

Motor protection: NEMA 3

Insulation class: F

Standard voltage: 115v 60Hz

# TECHNICAL DATA

## MATERIALS

| N° | PARTS*        | MATERIALS                 |
|----|---------------|---------------------------|
| 1* | PUMP          | SEE ECOJET 110, 120 , 130 |
| 2* | HOSE          | TECHNOPOLYMER             |
| 3* | TANK MEMBRANE | BUTYL                     |
| 4* | TANK FLANGE   | TECHNOPOLYMER             |
| 5* | OR GASKET     | NBR                       |
| 6  | AIR VALVE     | NBR                       |
| 7  | TANK BODY     | NBR                       |
| 8  | VALVE CAP     | TECHNOPOLYMER             |

\* In contact with liquid

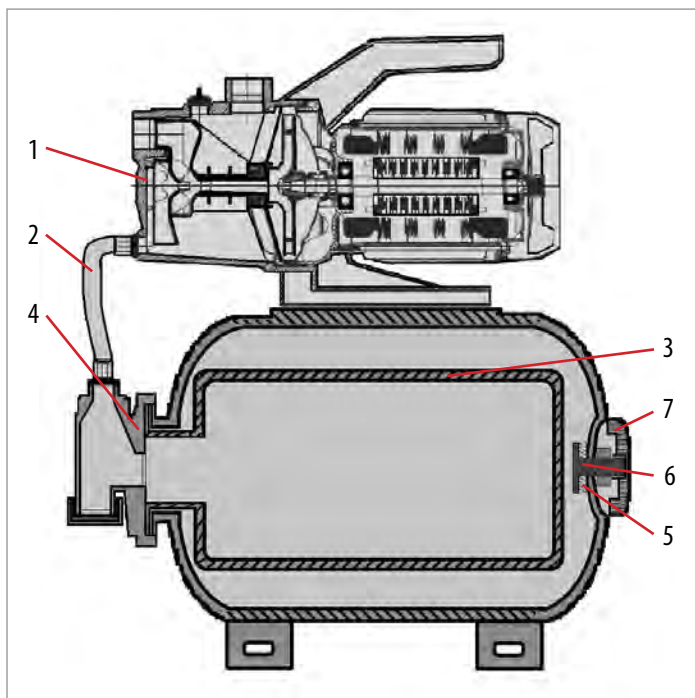

|                              |                                                                                                                                                          |
|------------------------------|----------------------------------------------------------------------------------------------------------------------------------------------------------|
| Operating Range:             | ECOMATIC 110 to 130 From 1 to 21gpm with a head up to 164ft ( 71 psi )                                                                                   |
| Liquid quality requirements: | clean, free from solids or abrasive substances, non viscous, non aggressive, non crystallized, chemically neutral, close to the characteristics of water |
| Liquid temperature Range:    | From 32°F to 104°F                                                                                                                                       |
| Maximum suction depth        | 26 ft                                                                                                                                                    |
| Maximum ambient temp.        | 104°F                                                                                                                                                    |
| Maximum operating pressure   | 116 psi                                                                                                                                                  |
| Installation:                | fixed or portable in a horizontal position                                                                                                               |
| Special version on request   | other voltages and/or frequencies                                                                                                                        |

# ECOMATIC 110

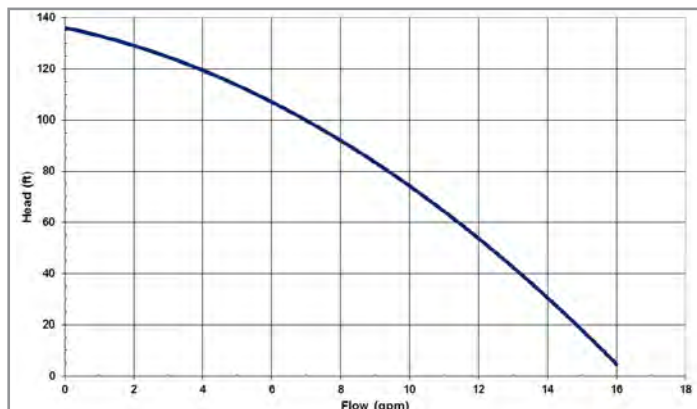
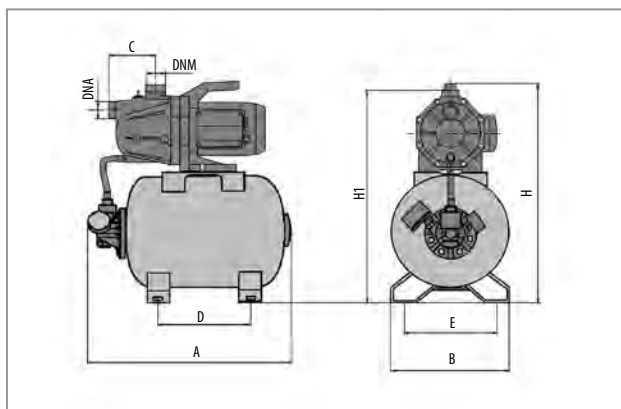

| MODEL        | A    | B    | C                               | D                               | E                               | H                                | H1   | DNA    | DNM    | Weight   |
|--------------|------|------|---------------------------------|---------------------------------|---------------------------------|----------------------------------|------|--------|--------|----------|
| ECOMATIC 110 | 18 " | 11 " | 4 <sup>5</sup> / <sub>8</sub> " | 7 <sup>3</sup> / <sub>4</sub> " | 8 <sup>1</sup> / <sub>4</sub> " | 21 <sup>3</sup> / <sub>8</sub> " | 21 " | 1" NPT | 1" NPT | 27.8 lbs |

| MODEL        | ELECTRICAL DATA |      |    |         | HYDRAULIC DATA      |             |             |                 |
|--------------|-----------------|------|----|---------|---------------------|-------------|-------------|-----------------|
|              | Voltage<br>60Hz | P1   |    | In<br>A | Pre-Set<br>Pressure | MAX<br>Flow | Max<br>Head | Max<br>Pressure |
| ECOMATIC 110 | 115v            | Watt | Hp | 8.0     | 28 -50 psi          | 16 gpm      | 138 ft      | 60 psi          |

# ECOMATIC 120 F

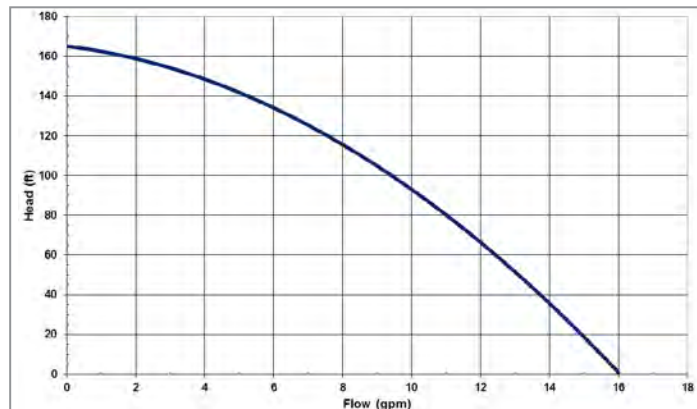
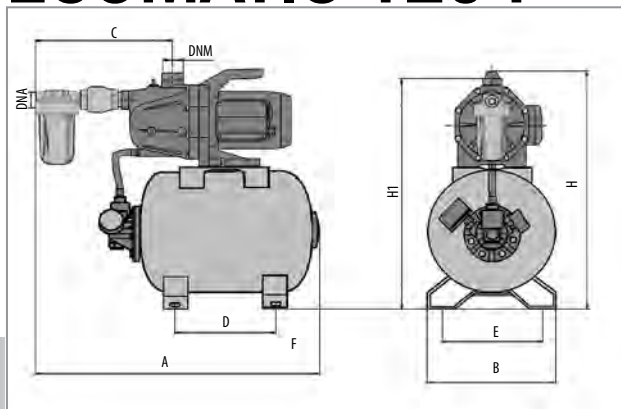

| MODEL          | A    | B    | C                               | D                               | E                               | H                                | H1   | DNA    | DNM    | Weight   |
|----------------|------|------|---------------------------------|---------------------------------|---------------------------------|----------------------------------|------|--------|--------|----------|
| ECOMATIC 120 F | 18 " | 11 " | 4 <sup>5</sup> / <sub>8</sub> " | 7 <sup>3</sup> / <sub>4</sub> " | 8 <sup>1</sup> / <sub>4</sub> " | 21 <sup>3</sup> / <sub>8</sub> " | 21 " | 1" NPT | 1" NPT | 27.8 lbs |

| MODEL          | ELECTRICAL DATA |      |     |         | HYDRAULIC DATA      |             |             |                 |
|----------------|-----------------|------|-----|---------|---------------------|-------------|-------------|-----------------|
|                | Voltage<br>60Hz | P1   |     | In<br>A | Pre-Set<br>Pressure | MAX<br>Flow | Max<br>Head | Max<br>Pressure |
| ECOMATIC 120 F | 115v            | 1000 | 3/4 | 10.0    | 36 -61 psi          | 16 gpm      | 164 ft      | 71 psi          |

\* IF version supplied with a 5" filter housing and sediment filter housing.

# ECOMATIC 130

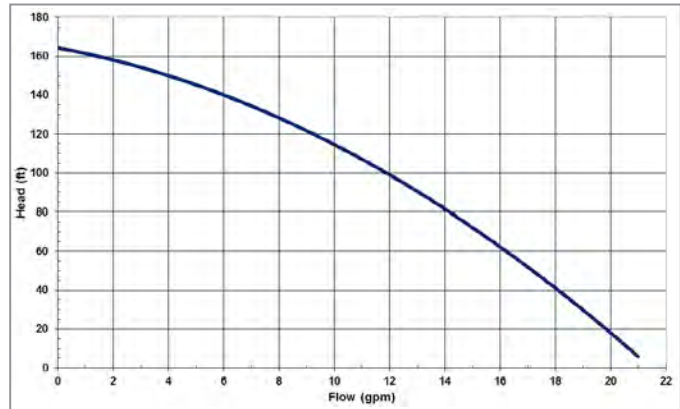
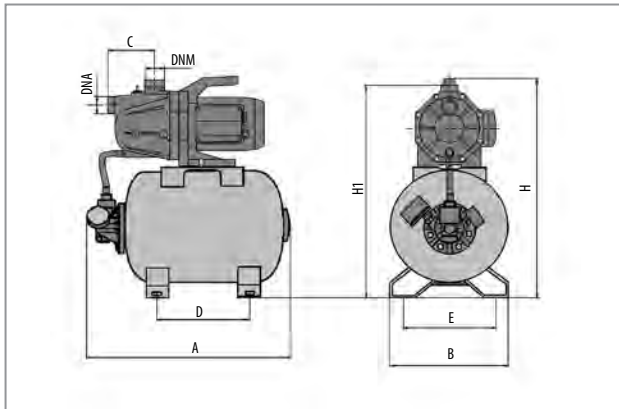

| MODEL        | A    | B    | C                               | D                               | E                               | H                                | H1   | DNA    | DNM     | Weight   |
|--------------|------|------|---------------------------------|---------------------------------|---------------------------------|----------------------------------|------|--------|---------|----------|
| ECOMATIC 130 | 18 " | 11 " | 4 <sup>5</sup> / <sub>8</sub> " | 7 <sup>3</sup> / <sub>4</sub> " | 8 <sup>1</sup> / <sub>4</sub> " | 21 <sup>3</sup> / <sub>8</sub> " | 21 " | 1" NPT | 1 " NPT | 32.0 lbs |

| MODEL        | ELECTRICAL DATA |      |    |         | HYDRAULIC DATA      |             |             |                 |
|--------------|-----------------|------|----|---------|---------------------|-------------|-------------|-----------------|
|              | Voltage<br>60Hz | P1   |    | In<br>A | Pre-Set<br>Pressure | MAX<br>Flow | Max<br>Head | Max<br>Pressure |
| ECOMATIC 130 | 115v            | Watt | Hp | 12.0    | 36 -61 psi          | 21 gpm      | 164 ft      | 71 psi          |

# HYDROTRONIC



## GENERAL DATA

### Applications

Electronic control system for surface and submersible pumps. Designed to allow the automatic operation of the pump and prevent it from dry-running.

Suitable for pumps with power up to 1.5 Hp with a flow rate up to 30 gpm.

The HYDROTRONIC has a manual and an automatic reset, a built-in non return valve.

It is easy to install and is supplied with power cable with plug and cable with socket for the connection to the pump.

## TECHNICAL DATA

|                              |                                                                                                                                                                |
|------------------------------|----------------------------------------------------------------------------------------------------------------------------------------------------------------|
| Operating Range:             | HYDROTRONIC RED From 1 to 30 gpm with a start pressure of 23 psi<br>HYDROTRONIC GREY From 1 to 30 gpm with a start pressure of 40 psi                          |
| Electrical Supply            | 115v 60Hz                                                                                                                                                      |
| Liquid quality requirements: | clean, free from solids or abrasive substances,<br>non viscous, non aggressive, non crystallized, chemically<br>neutral, close to the characteristics of water |
| Liquid temperature Range:    | From 32°F to 104°F                                                                                                                                             |
| Maximum ambient temp.        | 104°F                                                                                                                                                          |
| Maximum operating pressure   | 116 psi                                                                                                                                                        |
| Installation:                | fixed in a vertical position                                                                                                                                   |
| Special version on request   | other voltages and/or frequencies                                                                                                                              |

# TECHNICAL DATA

## MATERIALS

| N° | PARTS*                 | MATERIALS                                              |
|----|------------------------|--------------------------------------------------------|
| 1* | INLET CONNECTOR        | TECHNOPOLYMER                                          |
| 2* | NON RETURN VALVE       | TECHNOPOLYMER WITH NBR O RING & STAINLESS STEEL SPRING |
| 3* | FLOW SENSOR            | TECHNOPOLYMER                                          |
| 4  | PRESSURE SENSOR        | TECHNOPOLYMER                                          |
| 5* | PRESSURE SENSOR GASKET | NBR                                                    |
| 6* | FLOW SENSOR COVER      | TECHNOPOLYMER WITH NBR O RING                          |
| 7* | DISCHARGE BODY BODY    | TECHNOPOLYMER WITH CHROMED STEEL INSERT                |

\* In contact with liquid

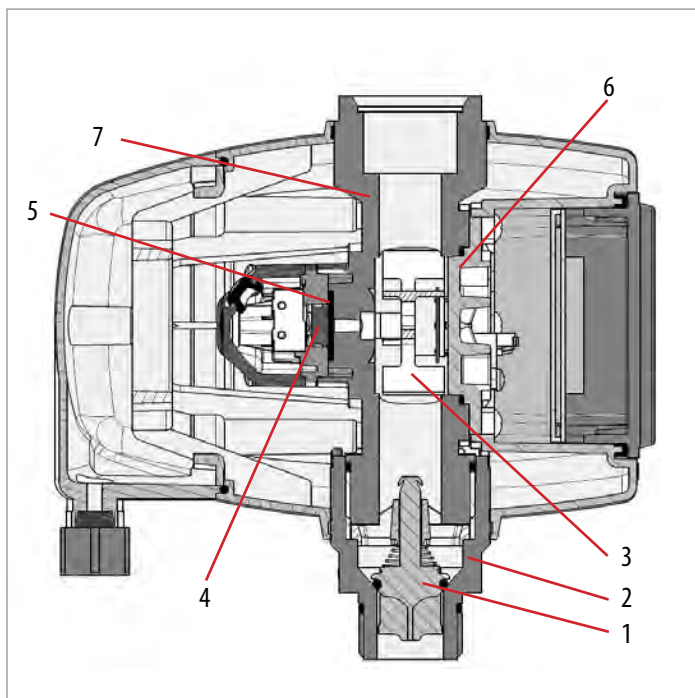

## DIMENSIONS

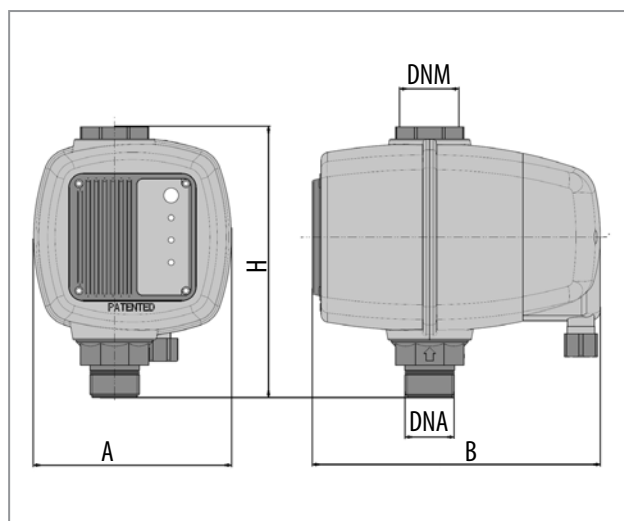

## FRICTION LOSS

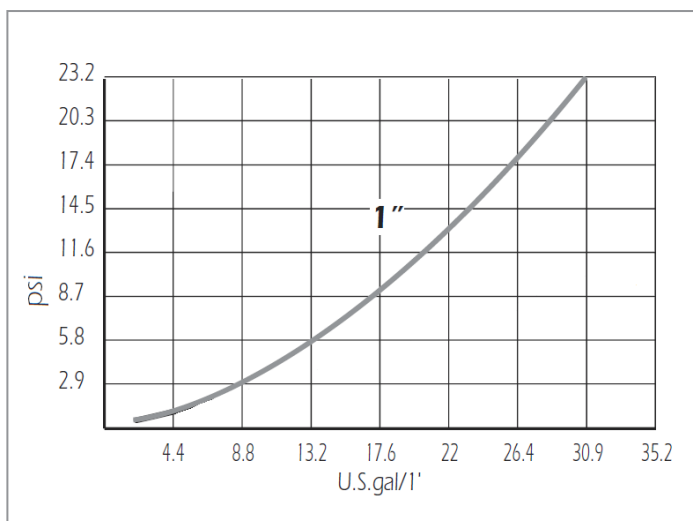

| MODEL       | A      | B      | H  | DNA    | DNM     | Weight  |
|-------------|--------|--------|----|--------|---------|---------|
| HYDROTRONIC | 5 1/4" | 7 1/4" | 7" | 1" NPT | 1 " NPT | 2.6 lbs |

# FILTER HOUSING & CARTRIDGES



## GENERAL DATA

### Applications

Filter housings and filter cartridges for the removal of sediment for water.

The transparent container allows the user to check the filter clogging level without opening the filter housing.

- \* Residential Homes
- \* Farming Applications
- \* Residential Irrigation
- \* Garden Irrigation Drip/Low Flow
- \* Hydroponics
- \* Rain Water Harvesting
- \* Water Supply from Shallow Wells

## TECHNICAL DATA

|                              |                                                                                                          |
|------------------------------|----------------------------------------------------------------------------------------------------------|
| Operating Range:             | 1 to 30 gpm                                                                                              |
| Liquid quality requirements: | non viscous, non aggressive, non crystallized, chemically neutral, close to the characteristics of water |
| Liquid temperature Range:    | From 32°F to 104°F                                                                                       |
| Maximum ambient temp.        | 104°F                                                                                                    |
| Maximum operating pressure   | 116 psi                                                                                                  |
| Installation:                | fixed in a vertical position                                                                             |



# TECHNICAL DATA

## MATERIALS

| N° | PARTS*               | MATERIALS           |
|----|----------------------|---------------------|
| 1* | TOP BODY             | TECHNOPOLYMER       |
| 2* | FILTER HOUSING       | CLEAR POLYCARBONATE |
| 3* | PRESSURE RELIEF PLUG | BRASS               |
| 4  | THREAD INSERTS       | BRASS               |
| 5* | O RING GASKET        | NBR                 |

\* In contact with liquid

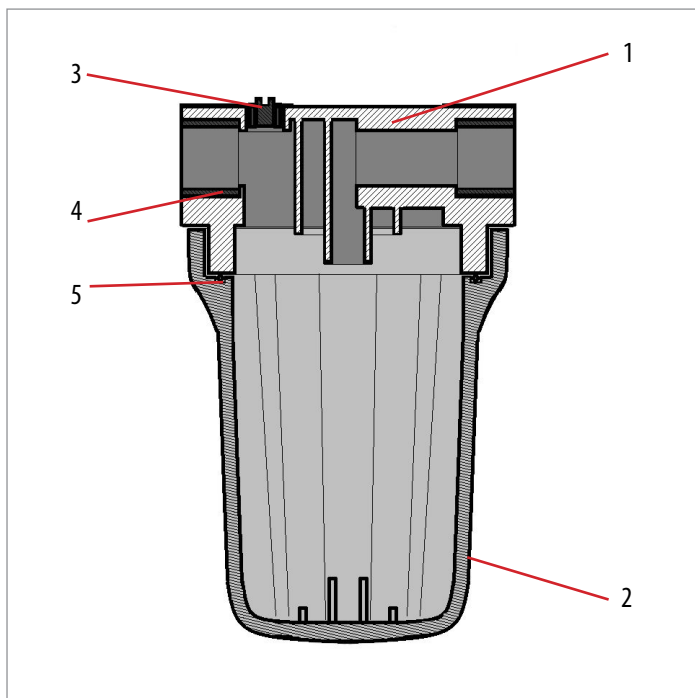

## DIMENSIONS

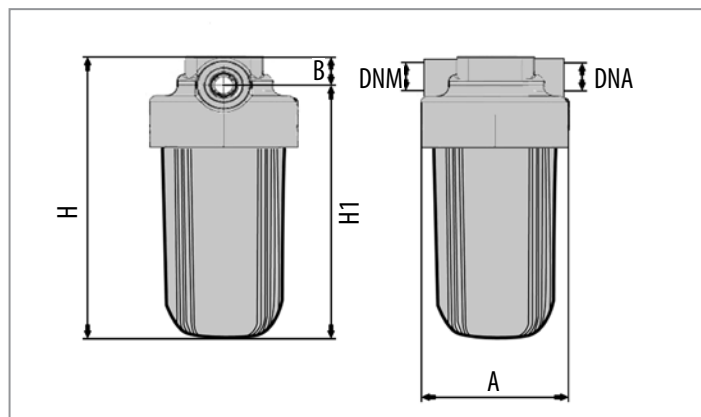

| MODEL  | FA 5 CLEAR                      | FA 10 CLEAR                      |
|--------|---------------------------------|----------------------------------|
| A      | 4 <sup>3</sup> / <sub>4</sub> " | 4 <sup>3</sup> / <sub>4</sub> "  |
| B      | 1 <sup>1</sup> / <sub>8</sub> " | 1 <sup>1</sup> / <sub>8</sub> "  |
| H      | 7 <sup>1</sup> / <sub>2</sub> " | 12"                              |
| H1     | 6 <sup>3</sup> / <sub>8</sub> " | 10 <sup>5</sup> / <sub>8</sub> " |
| DNM    | 1 " NPT                         | 1 " NPT                          |
| DNA    | 1 " NPT                         | 1 " NPT                          |
| WEIGHT | 1.6 lbs                         | 2.2 lbs                          |

## FILTER CARTRIDGE OPTIONS

| MODEL  | For Filter housing | Size | Filter type                   | micron |
|--------|--------------------|------|-------------------------------|--------|
| CRL 5  | FA 5               | 5"   | string wound sediment filter  | 20     |
| CRL 10 | FA 10              | 10"  | string wound sediment filter  | 20     |
| CF 5   | FA 5               | 5"   | mesh washable sediment filter | 60     |
| CF 10  | FA 10              | 10"  | mesh washable sediment filter | 60     |



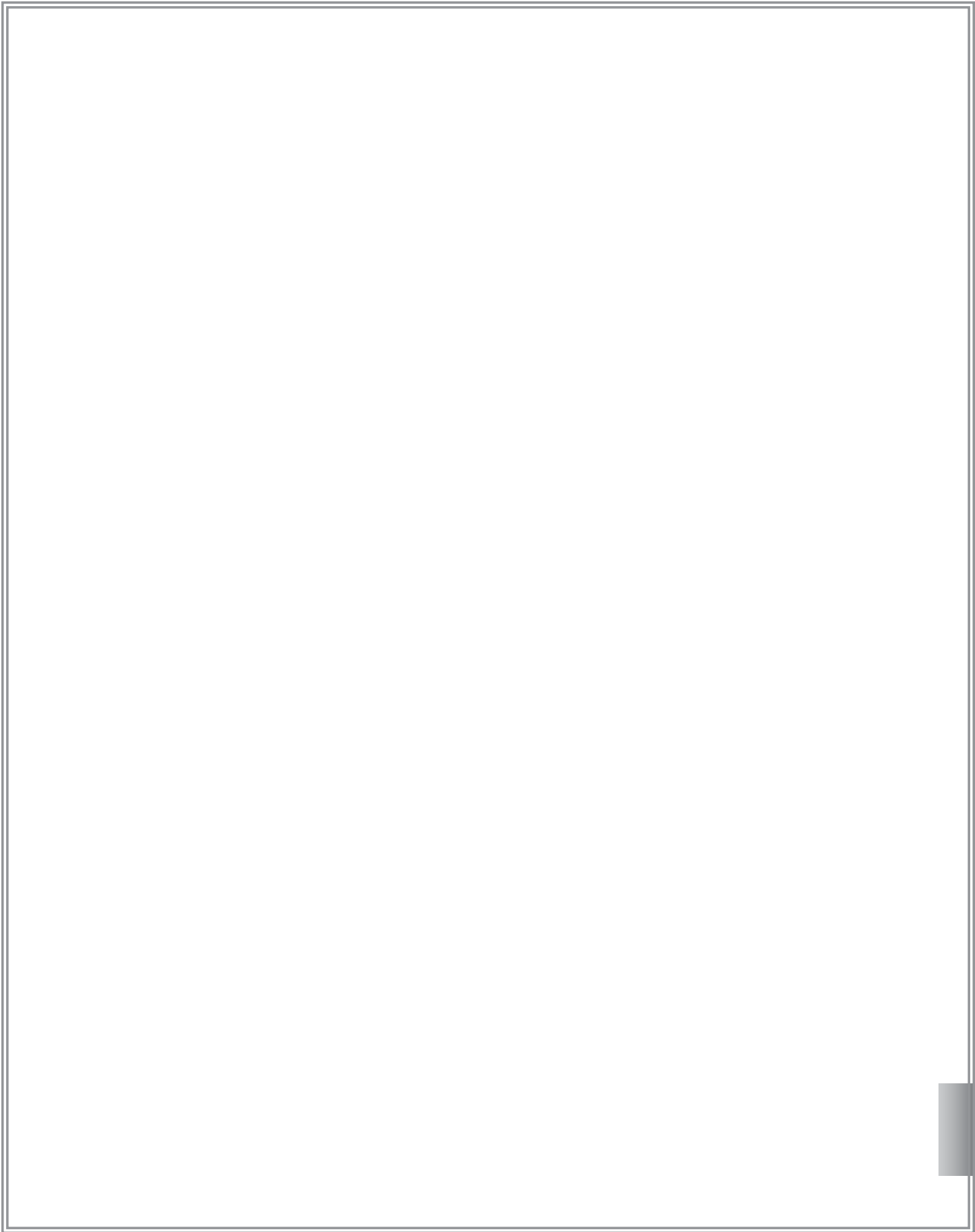



TEL: +1 (843) 797 5002  
FAX: +1 (843) 797 3366  
EMAIL: [info.usa@dwtgroup.com](mailto:info.usa@dwtgroup.com)  
WEB: [www.dabpumps.com](http://www.dabpumps.com)

**DAB PUMPS INC**  
3226 BENCHMARK DRIVE,  
LADSON SC 29456  
USA

**EMAIL** [orders.usa@dwtgroup.com](mailto:orders.usa@dwtgroup.com)

**EMAIL** [info.usa@dwtgroup.com](mailto:info.usa@dwtgroup.com)



**DAB PUMPS S.P.A.**  
VIA M polo, 14 35035  
Mestrino (PD) - Italy  
Tel.: +39 049 5125000  
Fax: +39 049 5125950



**DAB PUMPS B.V.**  
Albert Einsteinweg, 4  
5151 DL Drunen - Nederland  
[info.netherlands@dwtgroup.com](mailto:info.netherlands@dwtgroup.com)  
Tel. +31 416 387280  
Fax +31 416 387299



**DWT South Africa**  
Podium at Menlyn,  
3rd Floor, Unit 3001b, 43 Ingersol Road,  
C/O Lois and Atterbury street,  
Menlyn, Pretoria, 0181, South-Africa  
[info.sa@dwtgroup.com](mailto:info.sa@dwtgroup.com)  
Tel +27 12 361 3997  
Fax +27 12 361 3137



**DAB PUMPS B.V.**  
Brusselstraat 150  
B-1702 Groot-Bijgaarden - Belgium  
[info.belgium@dwtgroup.com](mailto:info.belgium@dwtgroup.com)  
Tel. +32 2 4668353  
Fax +32 2 4669218



**DAB PUMPEN DEUTSCHLAND GmbH**  
Tackweg 11  
D - 47918 Tönisvorst - Germany  
[info.germany@dwtgroup.com](mailto:info.germany@dwtgroup.com)  
Tel. +49 2151 82136-0  
Fax +49 2151 82136-36



**DAB POLAND - Representative Office**  
Mokotow Marynarska  
Ul. Postepu 15c - 3rd Floor  
02-676 Warsaw - POLAND  
Tel. +48 223 81 6085



**DAB PUMPS LIMITED**  
UNIT 3 STORTFORD HALL IND PK  
BISHOPS STORTFORD, HERTS, CM2 5GZ - UK  
[salesuk@dwtgroup.com](mailto:salesuk@dwtgroup.com)  
Tel. +44 1279 652776  
Fax +44 1279 657727



**DAB PUMPS IBERICA S.L.**  
Parque Empresarial San Fernando  
Edificio Italia Planta 1ª  
28830 - San Fernando De Henares - Madrid  
Spain  
[info.spain@dwtgroup.com](mailto:info.spain@dwtgroup.com)  
Tel. +34 91 6569545  
Fax: +34 91 6569676



**DAB UKRAINE Representative Office**  
Regus Horizon Park  
4 M. Hrinchenka St, suit 116  
03680 Kiev, UKRAINE  
Tel. +380 44 3195943



**OOO DWT GROUP**  
100 bldg. 3 Dmitrovskoe highway  
127247 Moscow - Russia  
[info.russia@dwtgroup.com](mailto:info.russia@dwtgroup.com)  
Tel. +7 495 739 52 50  
Fax +7 495 485-3618



**DAB PUMPS CHINA**  
No.40 Kaituo Road, Qingdao Economic & Technological  
Development Zone  
Qingdao City, Shandong Province, China  
PC: 266500  
[info.china@dwtgroup.com](mailto:info.china@dwtgroup.com)  
Fax +8653286812210  
Tel. +8653286812030-6270



**DAB PRODUCTION HUNGARY KFT.**  
H-8800  
NAGYKANIZSA, Buda Ernő u.5  
HUNGARY  
Tel. +36.93501700